







Designation Plan

Land to be Designated
New Milldale Station and Associated Facilities

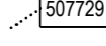
- Legend**
-  Proposed Designation
 -  Parcel Boundary
 -  507729 Property ID
 -  Existing Designation

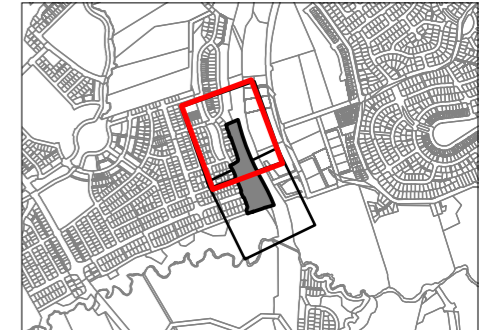

This map contains data derived in part or wholly from sources other than those party to the Supporting Growth Alliance, and therefore, no representations or warranties are made by those party to the Supporting Growth Alliance as to the accuracy or completeness of this information.

Map intended for distribution as a PDF document.
Scale may be incorrect when printed.

Contains information sourced from LINZ. Crown Copyright Reserved.

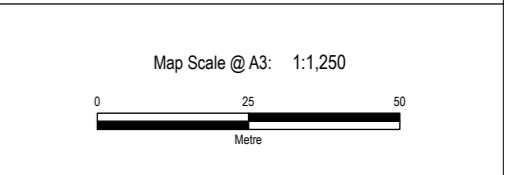

Revision	Author	Verified	Approved	Date
1	BAP	RR9	KB	20/07/2023

Client: **Auckland Transport / Waka Kotahi** Discipline: **GIS**

Project: **North Projects** Drawing No: **SGA-PA-N-001**
Sheet No : 1 of 2



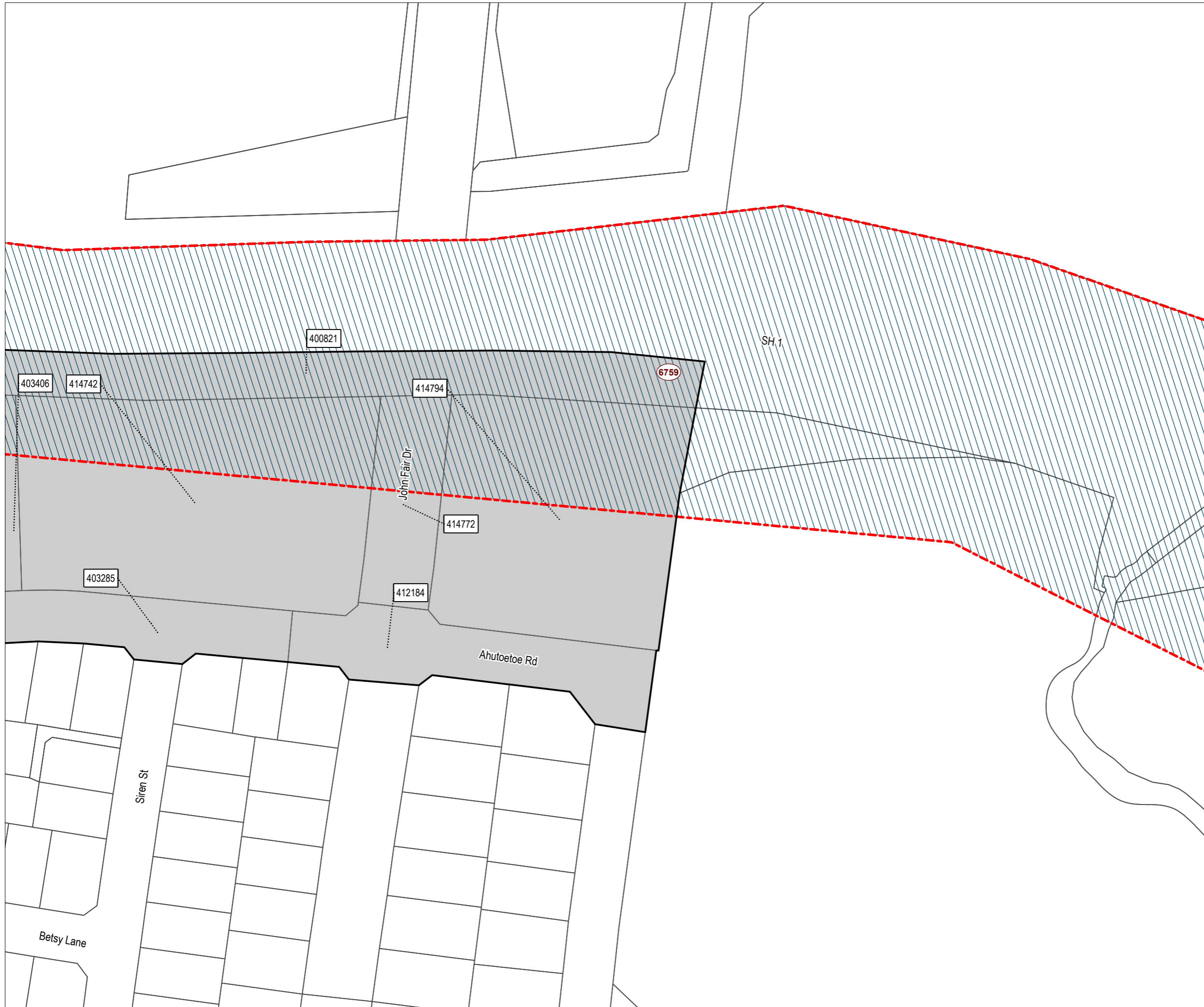

Designation Plan

Land to be Designated
New Milldale Station and Associated Facilities

Legend

- Proposed Designation
- Parcel Boundary
- 507729 Property ID
- Existing Designation

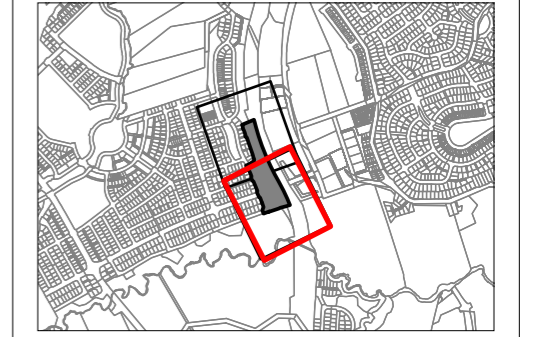

This map contains data derived in part or wholly from sources other than those party to the Supporting Growth Alliance, and therefore, no representations or warranties are made by those party to the Supporting Growth Alliance as to the accuracy or completeness of this information.

Map intended for distribution as a PDF document.
Scale may be incorrect when printed.

Contains information sourced from LINZ. Crown Copyright Reserved.

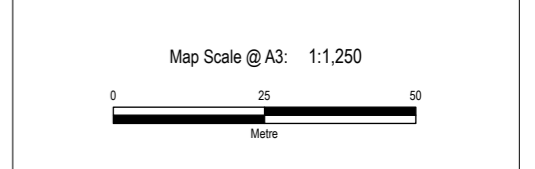

Revision	Author	Verified	Approved	Date
1	BAP	RR9	KB	20/07/2023

Client: Auckland Transport / Waka Kotahi

Discipline: GIS

Project: North Projects

Drawing No: SGA-PA-N-001
Sheet No : 2 of 2

