

Landscape Plan Set for

Stratford Properties Ltd

Stratford Properties
278 Clevedon-Kawakawa Road,
Clevedon

9012/1 - Master Landscape Plan	5/09/19
9012/2 - Housing Development Planting Plan - Part 1	5/09/19
9012/3 - Housing Development Planting Plan - Part 2	5/09/19
9012/4 - Restoration Planting Plan - Zone A	5/09/19
9012/5 - Restoration Planting Plan - Zone B	5/09/19
9012/6 - Restoration Planting Plan - Zone C	5/09/19
9012/7 - Fencing Plan Part 1	5/09/19
9012/8 - Fencing Plan Part 2	5/09/19
9012/9 - Planting Detail	5/09/19





- Zone Boundary
- Stream



Code	Name	Common Name	PB	Spacing	Quantity
PT	<i>Podocarpus totara</i> 'Matapouri Blue'	matapouri totara		95	Marked 44
DD	<i>Dacrycarpus dacrydioides</i>	Kahikatea		95	Marked 43
HO	<i>Quercus ilex</i>	Holm oak		95	Marked 5
CV	<i>Carex virgata</i>	purei		3	600mm 1500
LA	Lawn Swale				

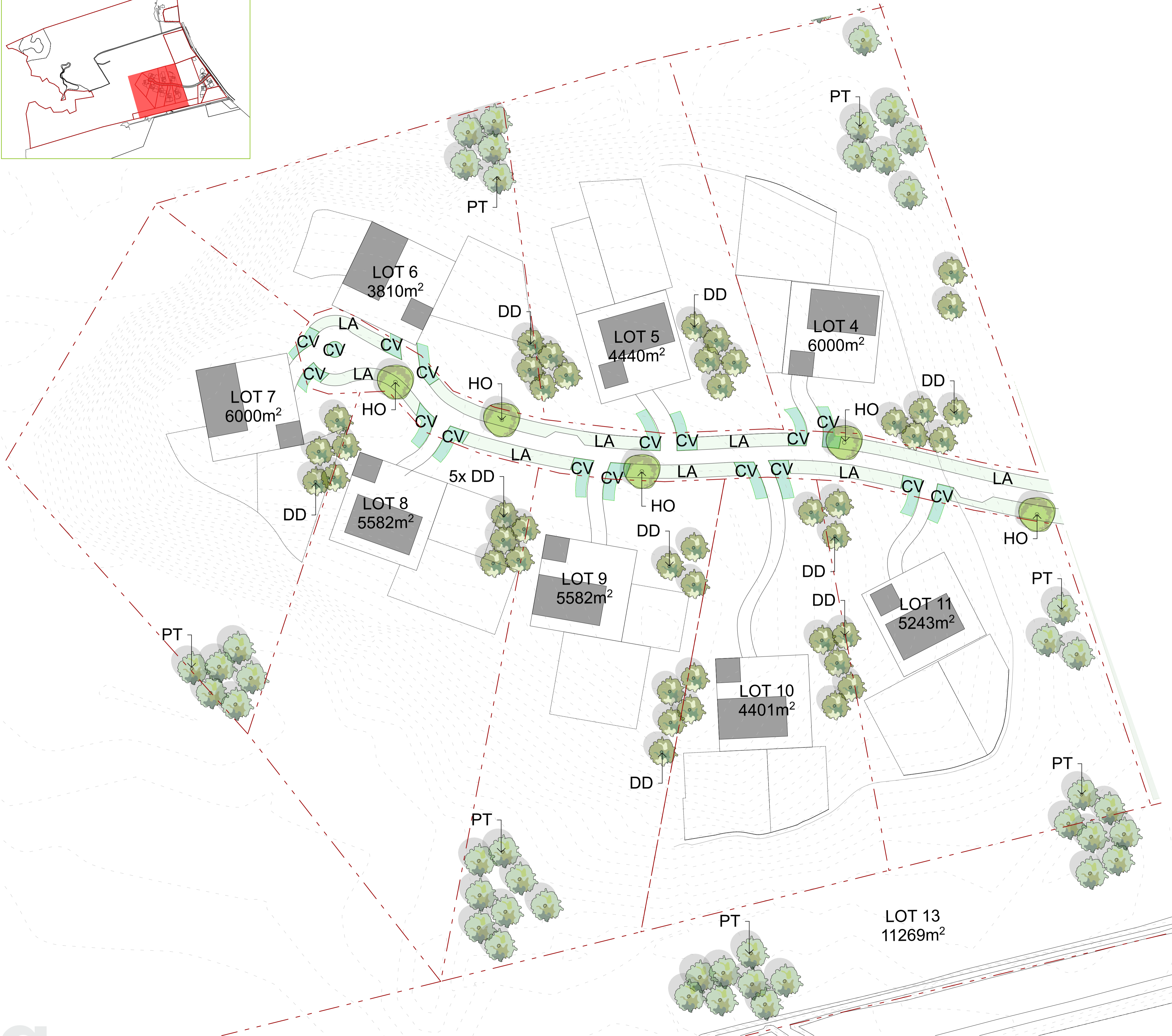

Quercus ilex



Podocarpus totara



Lawn swale



Dacrycarpus dacrydioides



Code	Name	Common Name	PB	Spacing	Quantity
DD	<i>Dacrycarpus dacrydioides</i>	Kahikatea		95	Marked
PT	<i>Podocarpus totara 'Matapouri Blue'</i>	matapouri totara		95	Marked
HO	<i>Quercus ilex</i>	Holm oak		95	Marked
GL	<i>Griselinia littoralis</i>	kapuka		40	1000mm
AF	<i>Austroderia fulvida</i>	toetoe		5	800mm
CV	<i>Carex virgata</i>	purei		3	600mm
PH	<i>Phormium tenax</i>	harakeke		5	1000mm
PC	<i>Phormium cookianum</i>	wharariki		3	1000mm
LA	Lawn Swale				

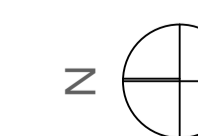



Code	Name	Common Name	PB	Spacing	Quantity	
DD	<i>Dacrycarpus dacrydioides</i>	Kahikatea		95	Marked	35
AF	<i>Austroderia fulvida</i>	toetoe		0.5L	1500mm	445
AP	<i>Apodasmia similis</i>	oi oi		0.5L	800mm	4188
CV	<i>Carex virgata</i>	purei		0.5L	600mm	11469
PH	<i>Phormium tenax</i>	harakeke		0.5L	1000mm	7760

Planting as per the 4Sight Consulting 278 Clevedon - Kawakawa Ecology Report



DD
Dacrycarpus dacrydioides



AF
Austroderia fulvida



CV
Carex virgata



PH
Phormium tenax



AP
Apodasmia similis



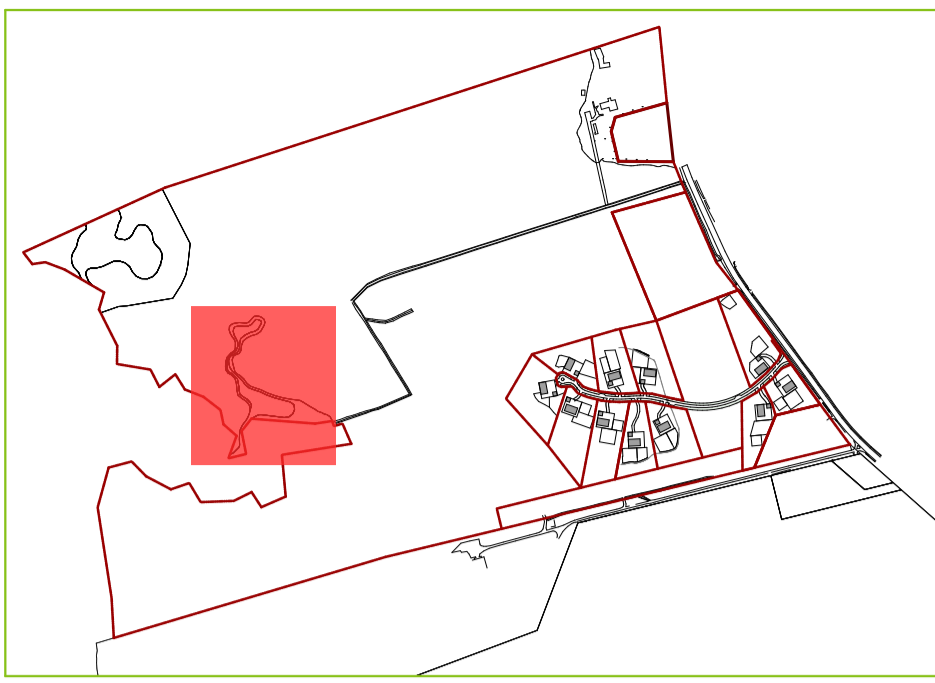

Code	Name	Common Name	PB	Spacing	Quantity
Stream Edge Zone					
ED1	Carex secta 30%	purei		0.5L 1000mm	2293
ED1	Coprosma robusta 20%	karamu		0.5L 1000mm	764
ED1	Coprosma propinqua 20%	mingimingi		0.5L 1000mm	764
ED1	Gahnia xanthocarpa 20%	giant sedge		0.5L 1500mm	340
Stream Reserve Zone					
RE1	Austroderia fulvida 15%	toetoe		0.5L 1000mm	495
RE1	Cordyline australis 10%	ti kouka		1.5L 4000mm	21
RE1	Carex virgata 15%	purei		0.5L 1000mm	495
RE1	Myrsine australis 10%	matipo		1L 2000mm	83
RE1	Melicytus ramiflorus 5%	māhoe		1.5L 1500mm	73
RE1	Phormium tenax 40%	harakeke		0.5L 1000mm	1320
RE1	Sophora microphylla 5%	kōwhai		1.5L 4000mm	10

Planting as per the 4Sight Consulting 278 Clevedon - Kawakawa Ecology Report

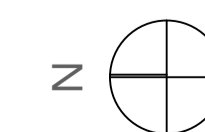

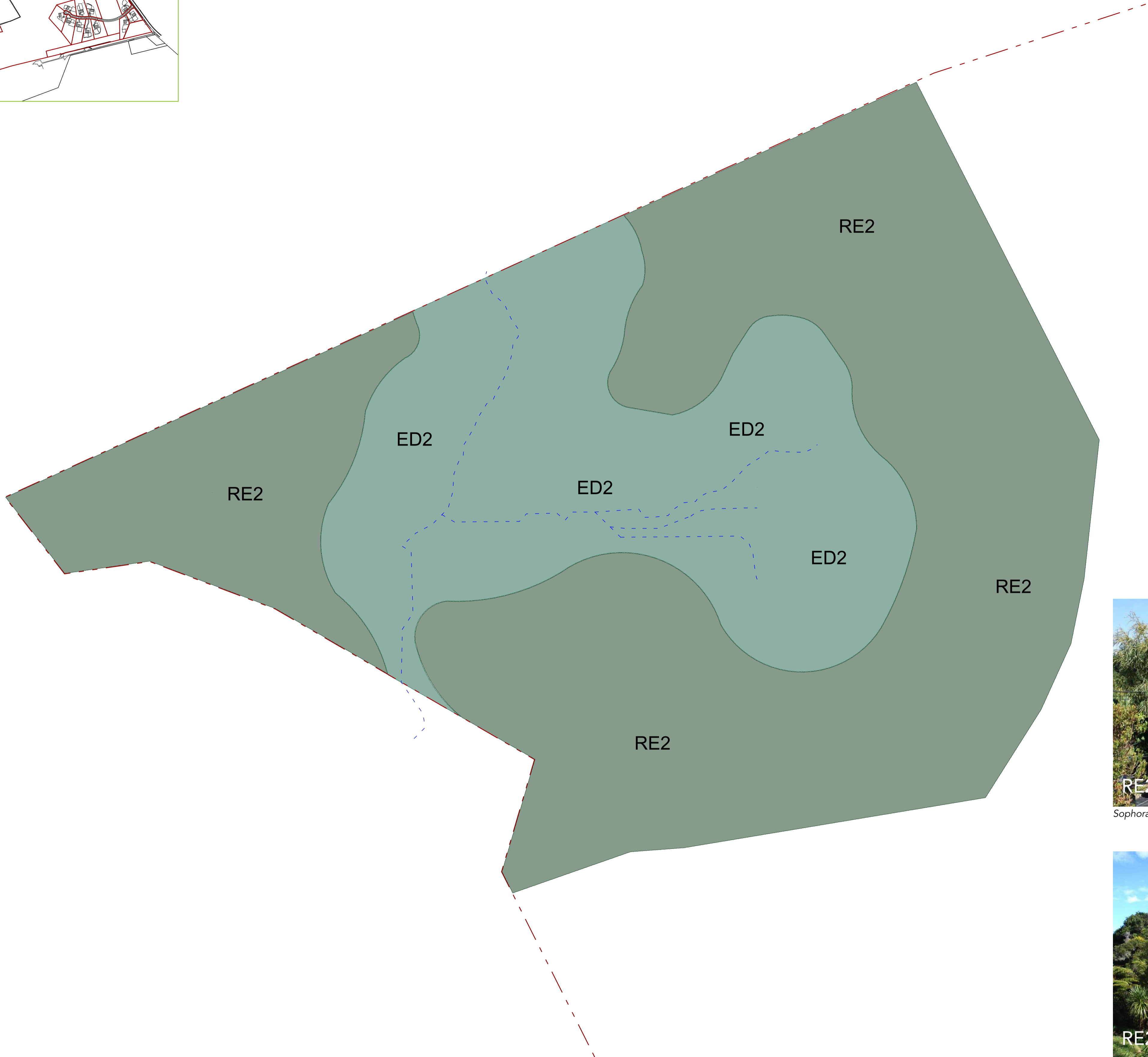

Code	Name	Common Name	PB	Spacing	Quantity
Stream Edge Zone					
ED2	<i>Apodasmia similis</i> 20%	oiioi		0.5L 600mm	4867
ED2	<i>Carex virgata</i> 20%	purei		0.5L 1000mm	1752
ED2	<i>Carex secta</i> 30%	purei		0.5L 500mm	10513
ED2	<i>Gahnia xanthocarpa</i> 30%	giant sedge		0.5L 1500mm	1168
Stream Reserve Zone					
RE2	<i>Austroderia fulvida</i> 20%	toetoe		0.5L 1500mm	1577
RE2	<i>Cordyline australis</i> 10%	ti kouka		1.5L 4000mm	111
RE2	<i>Dacrycarpus dacrydioides</i> 20%	Kahikatea		1.5L 6000mm	99
RE2	<i>Phormium tenax</i> 40%	harakeke		0.5L 1000mm	7095
RE2	<i>Sophora microphylla</i> 10%	kōwhai		1.5L 4000mm	111

Planting as per the 4Sight Consulting 278 Clevedon - Kawakawa Ecology Report

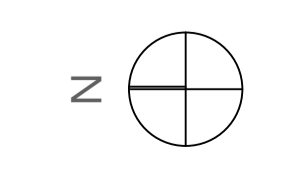



Code	Name	Specification
PR	Post and 2 rail fence	0.95m high, 150X50mm selected timber rails, 150X150mm selected timber posts at 1.95m centers
WF	Wire fence	100mm dia H4 SED posts with 50x50mm battens No.8 galv wire.

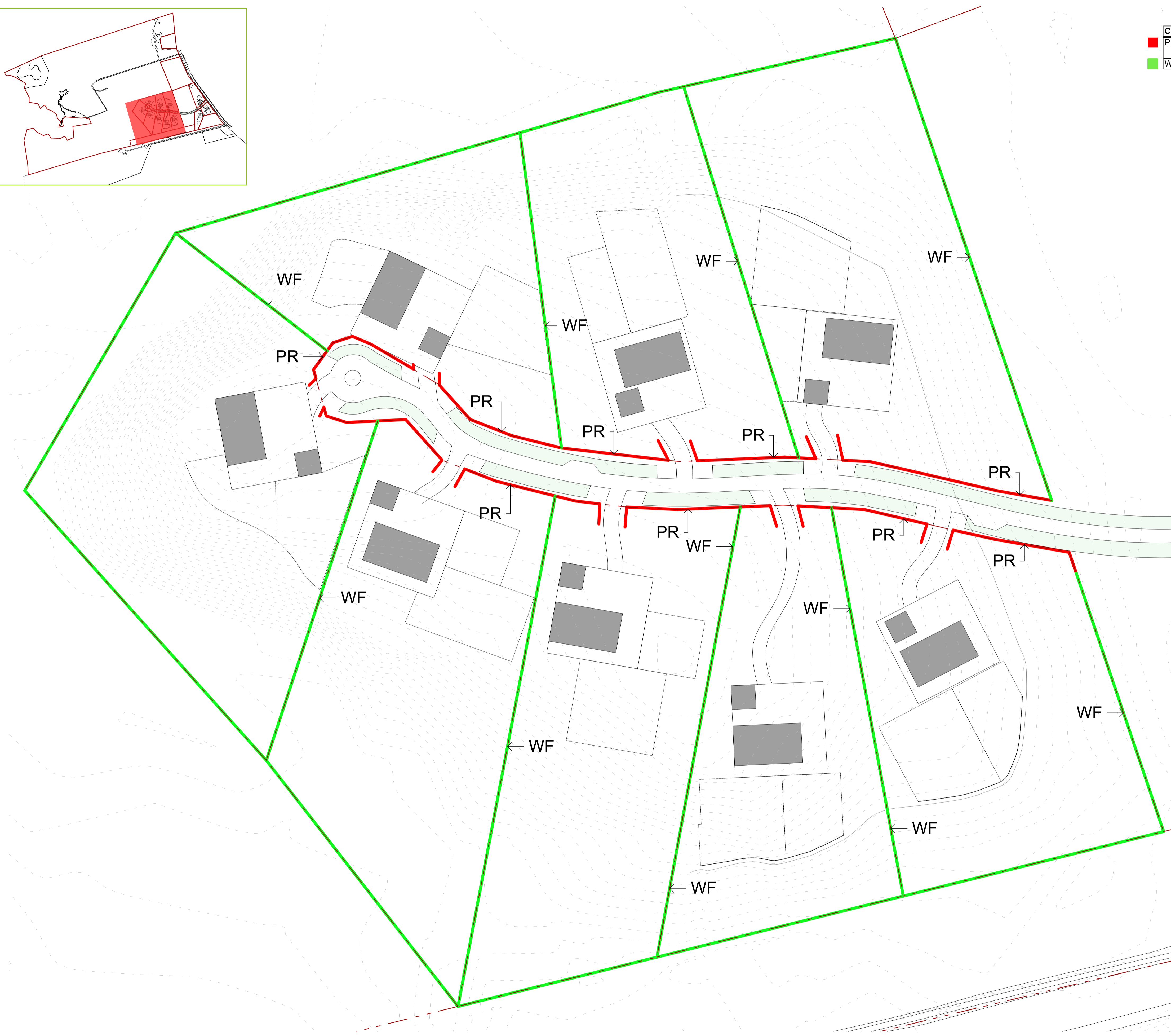

PR
Post and Rail



WF
Wire Fence



Code	Name	Specification
PR	Post and 2 rail fence	0.95m high, 150X50mm selected timber rails, 150X150mm selected timber posts at 1.95m centers
WF	Wire fence	100mm dia H4 SED posts with 50x50mm battens No.8 galv wire.

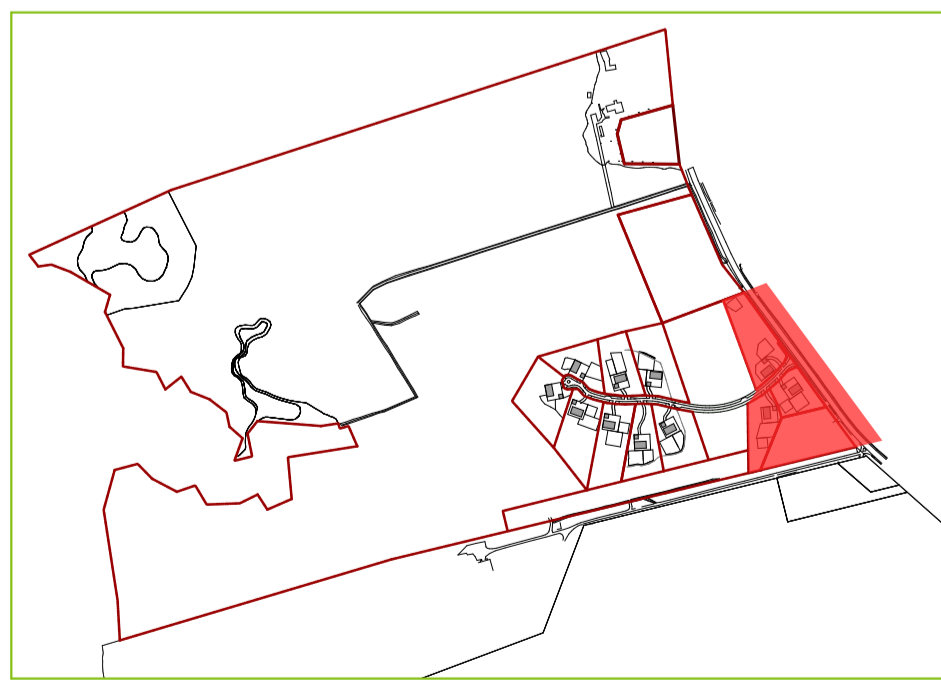
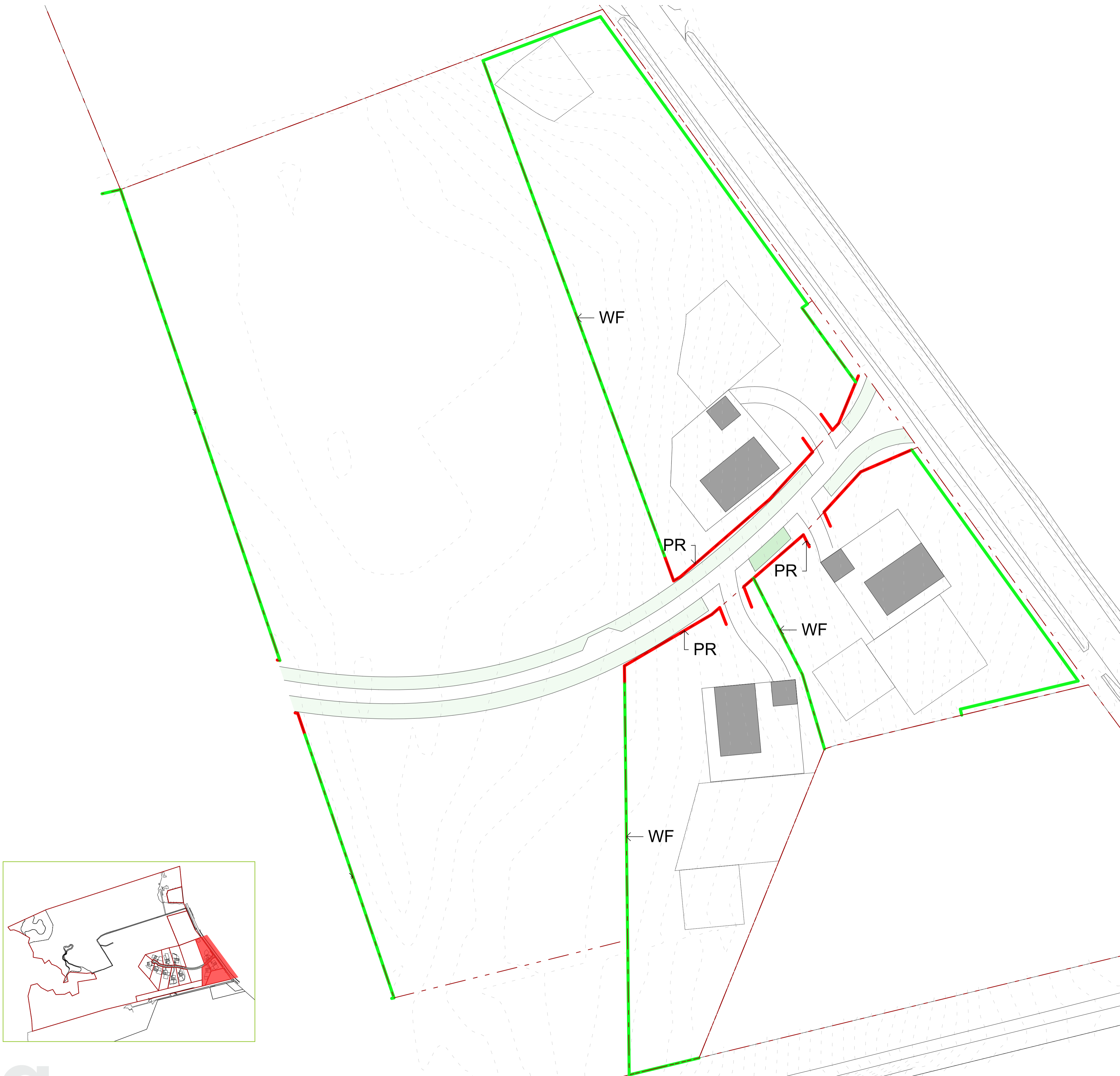

PR
Post and Rail



WF
Wire Fence



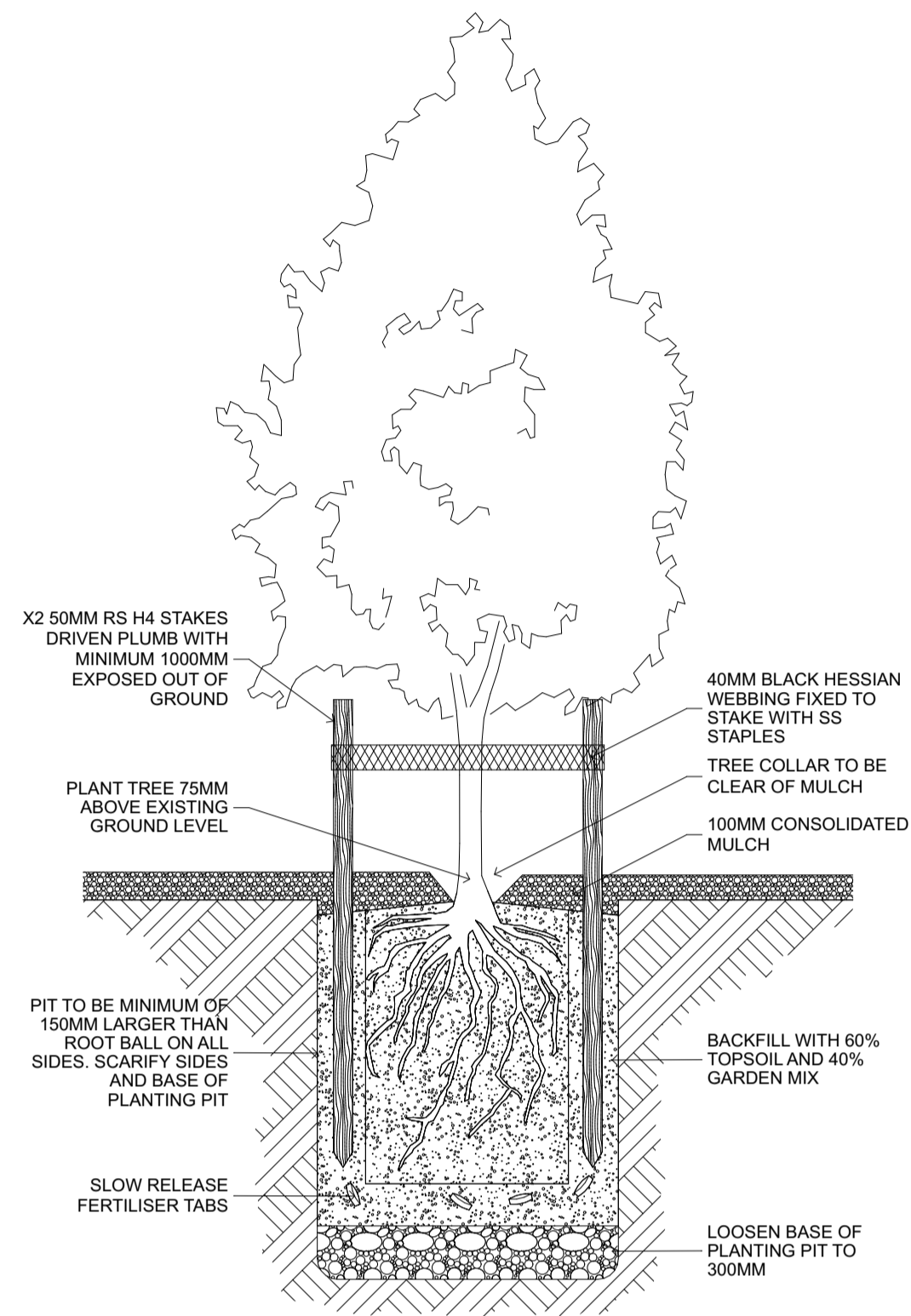

PD-01: TREE IN GARDEN NTS

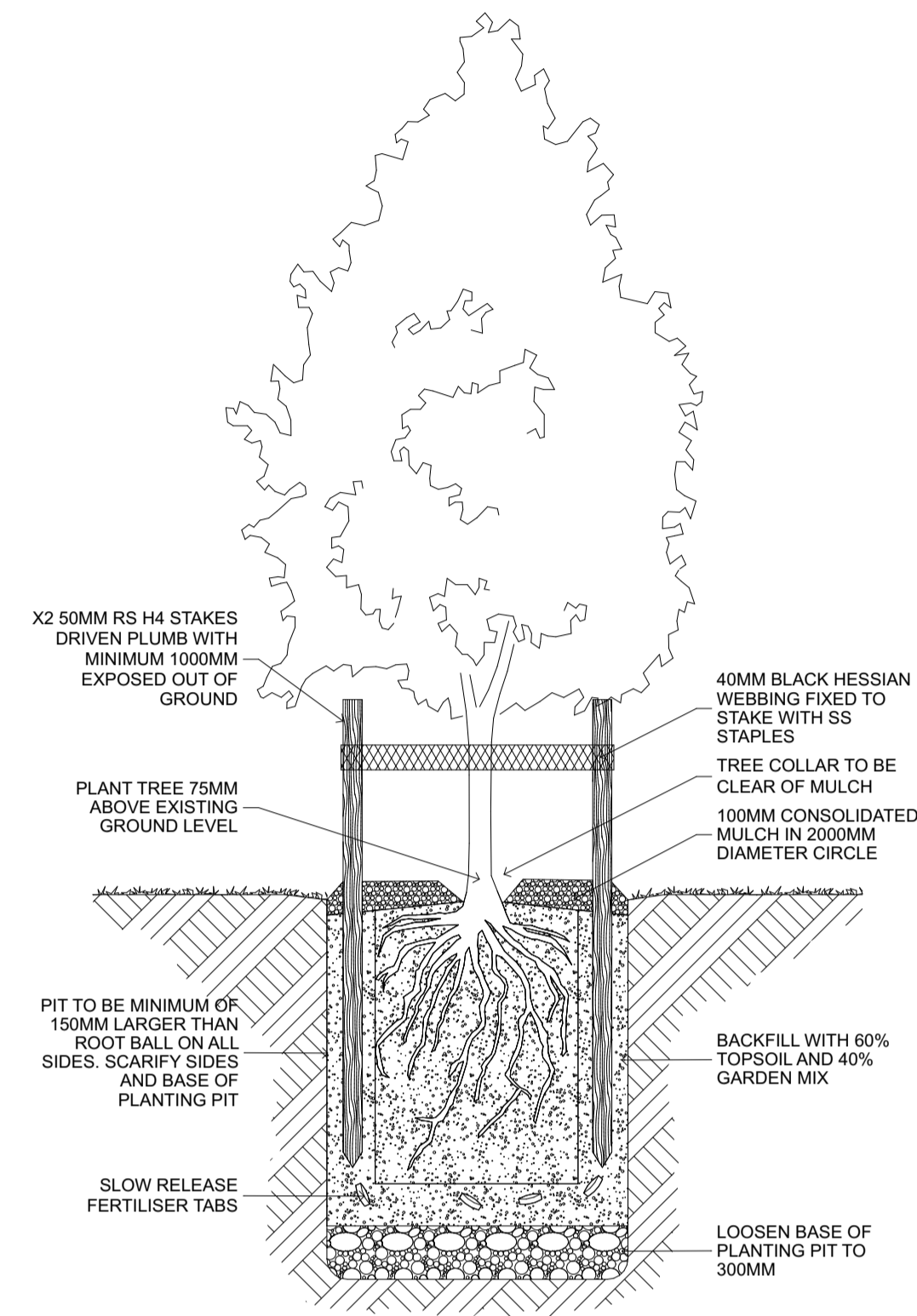

PD-02: TREE IN LAWN NTS

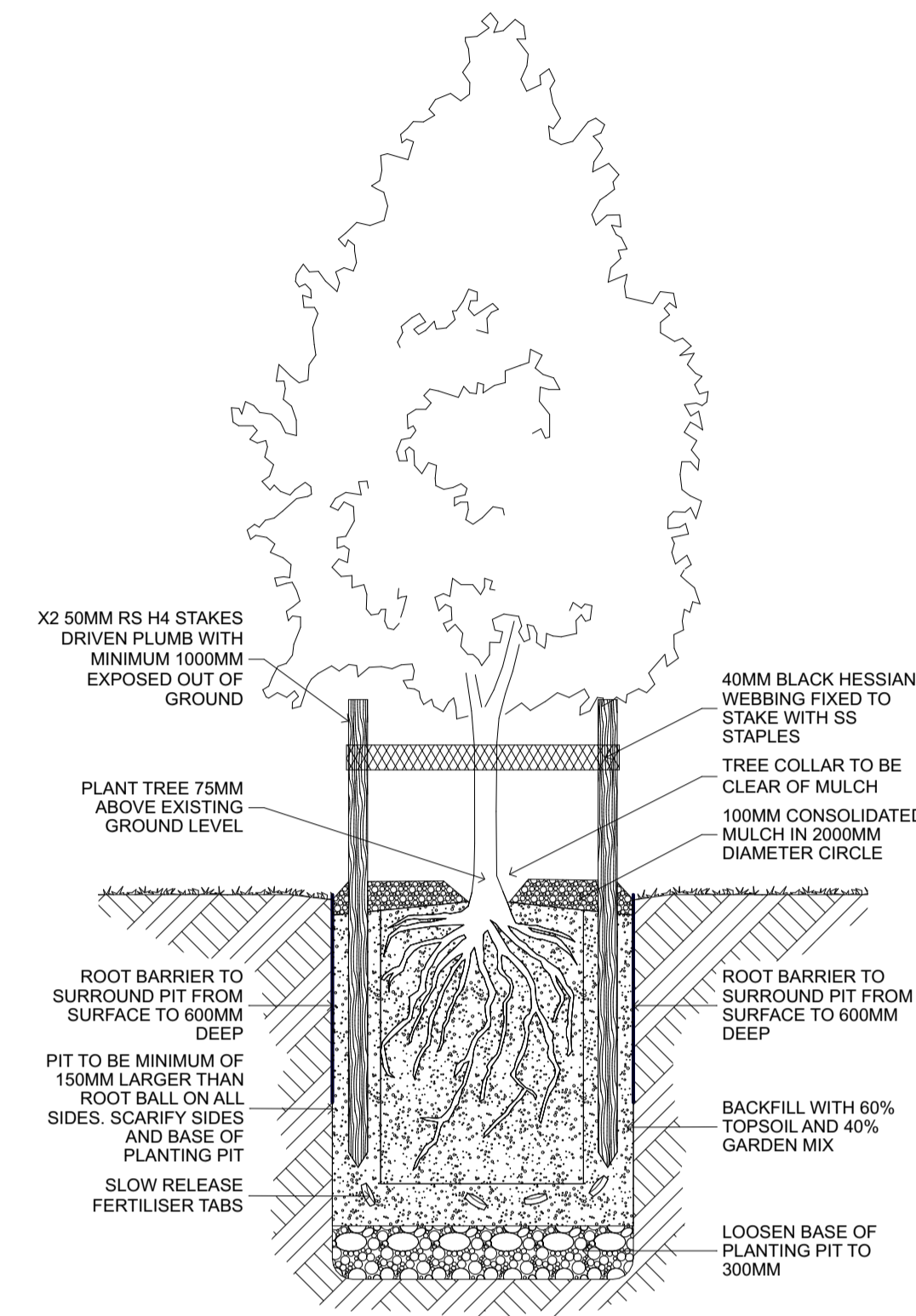

PD-03: STREET TREE IN LAWN/GARDEN NTS

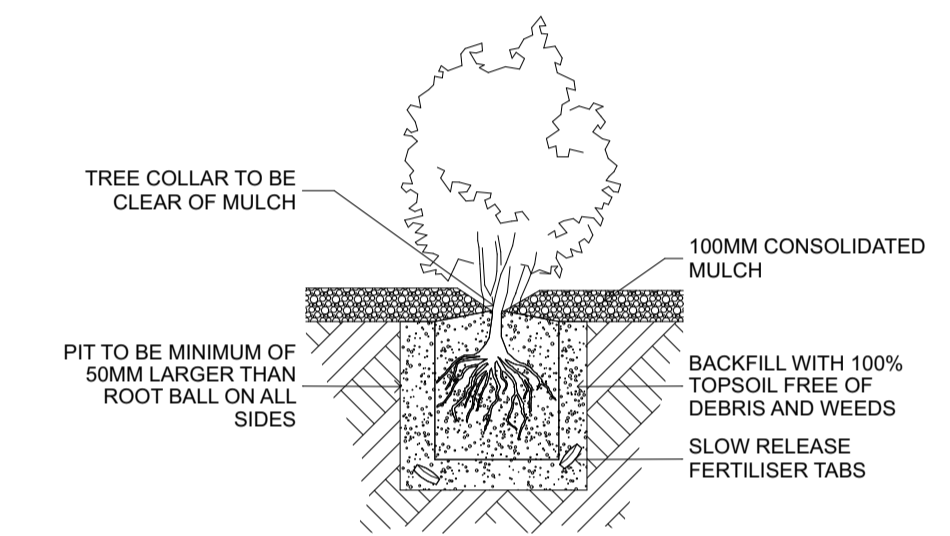
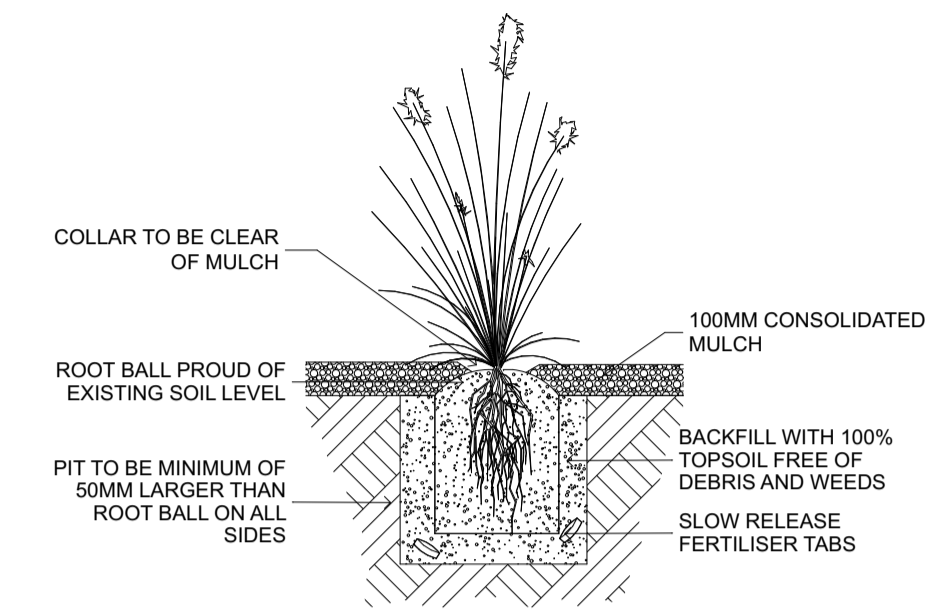

PD-04: SHRUB PLANTING NTS

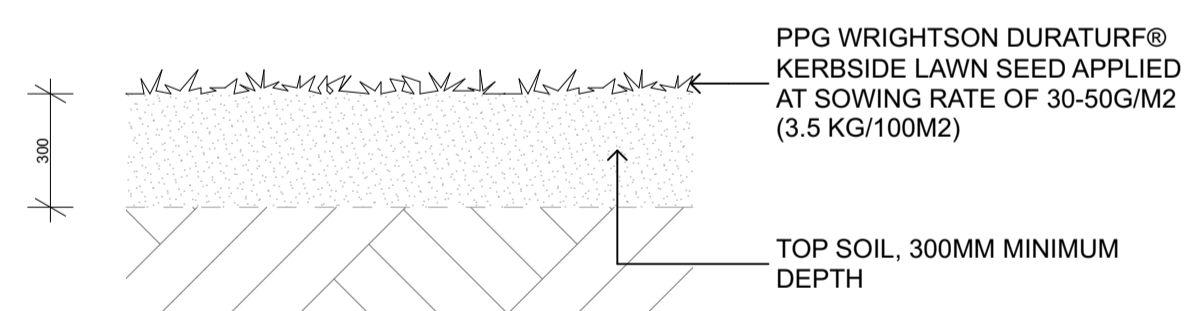

PD-06: LAWN 1:20@A1 / 1:40@A3