

MEMORANDUM OF EASEMENTS IN GROSS			
PURPOSE	SHOWN	BURDENED LAND	GRANTEE
PEDESTRIAN RIGHT OF WAY	(A)	LOT 1	AUCKLAND COUNCIL

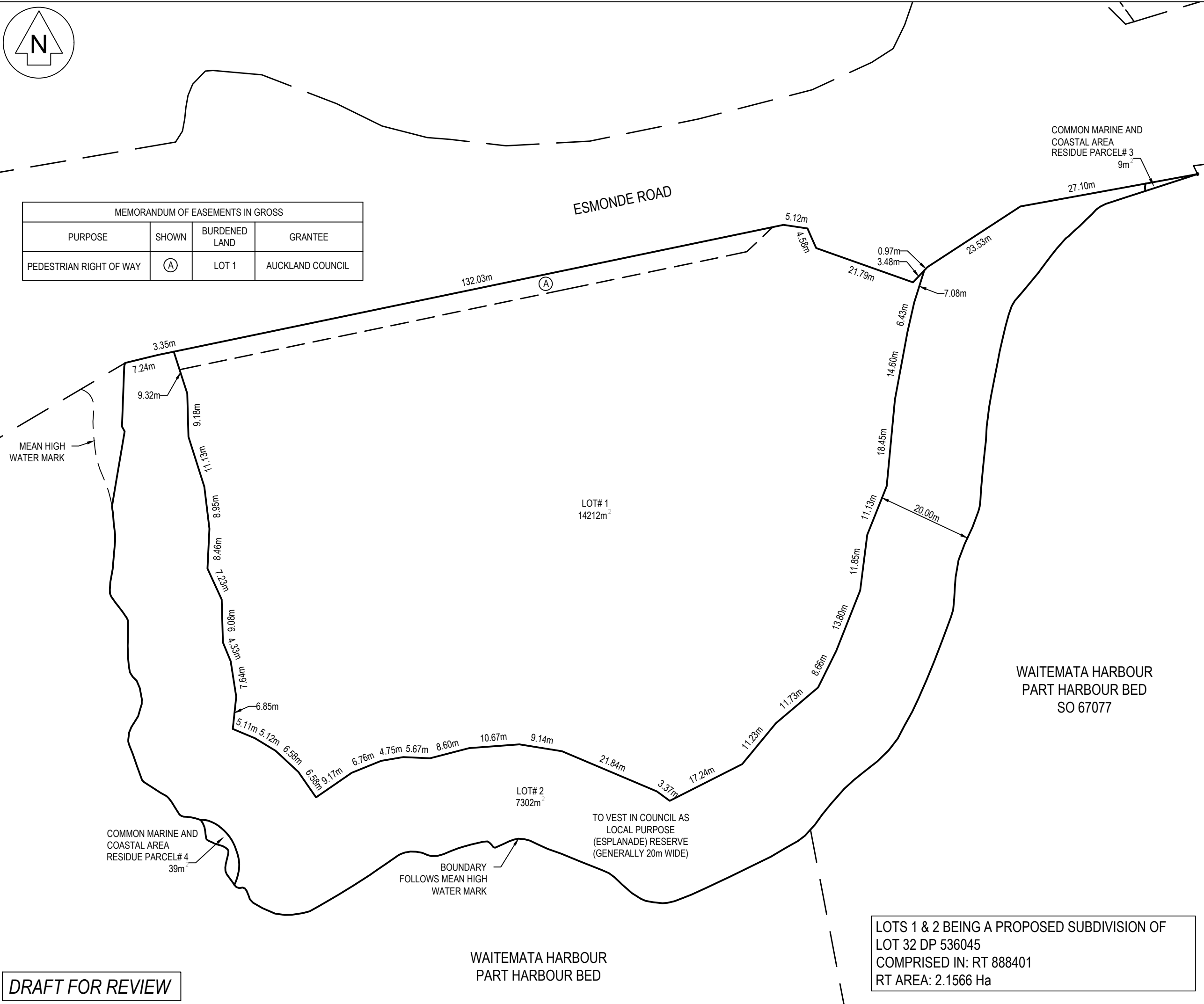

- Notes
- All works to be in accordance with Auckland council standards.
 - Co-ordinates in terms of NZ Geodetic Datum Mt Eden 2000
 - Levels in terms of the Auckland Vertical Datum 1946.
 - Boundaries are subject to final survey.

Legend

	PR BDY
	PR EASEMENT
	EX ABBUTTAL

Ref	Revisions	By	Date

Project
48 ESMONDE ROAD
TAKAPUNA
AUCKLAND
FOR
KINGSTONE PROPERTY

Title
PROPOSED
SCHEME
PLAN

Project no.	175001
Scale	1:250 @ A3
Cad file	111-DESIGN
Drawing no.	C100
Rev	A

DRAFT FOR REVIEW

LOTS 1 & 2 BEING A PROPOSED SUBDIVISION OF
 LOT 32 DP 536045
 COMPRISED IN: RT 888401
 RT AREA: 2.1566 Ha

WAITEMATA HARBOUR
 PART HARBOUR BED

WAITEMATA HARBOUR
 PART HARBOUR BED
 SO 67077

TO VEST IN COUNCIL AS
 LOCAL PURPOSE
 (ESPLANADE) RESERVE
 (GENERALLY 20m WIDE)

COMMON MARINE AND
 COASTAL AREA
 RESIDUE PARCEL# 4
 39m²

BOUNDARY
 FOLLOWS MEAN HIGH
 WATER MARK

LOT# 1
 14212m²

LOT# 2
 7302m²

ESMONDE ROAD