

Waitematā Local Board Workshop Agenda

Date of Workshop: 28/05/2024

Time: 9.30 am – 2.00 pm

Venue: Town Hall, Reception Lounge

Item	Time	Workshop Item	Presenter/s	Purpose	Governance Role
1	9.30 – 10.30	Welcome and Admin	Local Board Services Staff & Local Board Members	Opportunity for LBS staff to provide updates on key issues, upcoming work, and other matters of interest; and for members to raise issues and give updates on matters of interest to the wider board and staff.	Keeping informed
2	10.30 – 11.30	Parks and Community Facilities - Heard Park	Martin Wong – Manager Area Operations Katrina Morgan – Work Programme Lead Jacqui Thompson Fell – Parks & Places Specialist Cath Duncan – Project Manager	Staff and the board to continue workshop the Heard Park Concept Plan following the previous discussion. Staff to seek the board’s direction on the next steps.	Keeping informed Local initiatives and specific decisions
	11.30 – 12.30	Break			

Item	Time	Workshop Item	Presenter/s	Purpose	Governance Role
3	12.30 – 2.00	Local Board Agreement		Staff and the board to discuss the content of the draft local board agreement 2024/2025, as well as to finalise the content of the draft local board agreement 2024/2025, which will be agreed at the local board business meeting in June 2024.	Setting direction, priorities and budgets

Next Ordinary Business meeting: 18/06/2024

Next workshop: 4/06/2024

Role of Workshop:

- a) Workshops do not have decision-making authority.
- b) Workshops are used to canvass issues, prepare local board members for upcoming decisions and to enable discussion between elected members and staff.
- c) Workshops are open to the public and decisions will be made at a formal, public local board business meeting.
- d) Members are respectfully reminded of their Code of Conduct obligations with respect to conflicts of interest and confidentiality.
- e) Workshops for groups of local boards can be held giving local boards the chance to work together on common interests or topic

Please read the guidance in grey and then delete before sending.
Remember, the body of your memo should be in black regular Arial 11.
For further guidance please refer to the [memo guidance](#).

Memorandum

23 May 2024

To: Waitematā Local Board

Subject: Heard Park - Developed Design Update

From: Cath Duncan, Project Manager, Parks and Community Facilities

Contact information: cath.duncan@aucklandcouncil.govt.nz

Purpose

1. To seek direction from the Waitematā Local Board on a staff recommendation to approve ground works only for Heard Park, 192 Parnell Road, Parnell in the 2025/2026 financial year work programme.

Summary

2. In August 2023, the Waitematā Local Board approved a concept plan and funding for the resource consent and detailed design phase for the redevelopment of Heard Park (resolution number WTM/2023/131).
3. Staff presented the 50 per cent developed design for local board review and feedback at a workshop in April 2024, with the intention of progressing to final detailed design.
4. Staff shared the 50 per cent developed design with the Parnell Business Association and Parnell Community Committee. However, these stakeholders have raised concerns about the design, which they presented at the 21 May 2024 local board business meeting.
5. Confirmation of funding will be required for the physical works for the redevelopment, and budget will be included in the proposed 2024/2025 financial year work programme which will be presented to the local board in June 2024.
6. Staff will present the detailed design for stage one project works to the local board at a workshop in July 2024.
7. The local board direction will ensure that this project will be included in the work programme.

Context

8. The development of a concept design for Heard Park was an approved project in the 2019/2020 Customer and Community Services work programme (resolution number WTM/2019/121).
9. At the 15 August 2023 business meeting, the Waitematā Local Board approved the Heard Park concept design (resolution number WTM/2023/131) and allocated \$32,000 locally driven initiatives (LDI) capex funding to progress the concept design to detailed design and consent (Attachment A - Heard Park Developed Design).

10. The local board resolution noted that additional engagement with external stakeholders, iwi, and the community was to be undertaken as part of the resource consenting phase, and that a phased approach for development may need to be considered as the local board prioritises future work programme activities.
11. Development of Heard Park aligns with the Waitematā Local Board Plan 2023 Outcome 3 'Our Community'. A key initiative for 'Our Community' is to 'work with the business and residential community to progress the detailed design and redevelopment of Heard Park'.
12. Staff undertook extensive consultation with key stakeholders and the local community in planning and developing the concept plan. A public 'Have Your Say' campaign involved an additional 78 contributors. Retention of the mature trees, open lawn space and adequate seating areas for leisure are key themes that have been explored in this design.
13. Specific concerns regarding artful play were raised by both the Parnell Business Association (PBA) and the Parnell Community Committee (PCC), and subsequently, staff held meetings to understand the desired outcomes for the park from these key stakeholders. Following the recent local board business meeting held on 21 May 2024, the concerns of these stakeholders are yet to be resolved, particularly regarding artful play.
14. In order to continue to resource consent and final detailed design, staff seek local board direction to proceed with ground works only as the first stage of the project. This will enable staff to confirm funding for the proposed 2024/2025 Parks and Community Facilities work programme.
15. Staff recommend that artful play including the area for the swings is considered as Stage Two, and potentially consider a community-led design, which will be refined through further discussions with elected members, the community and council staff.

Discussion

16. Following the approval of the concept design in August 2023, Parks and Community Facilities staff commissioned Bespoke Landscape Architects to assist with resource consent and to deliver the detailed design.
17. The approved concept design has now been assessed against existing site conditions including a topographical survey, underground services locations and arborist advice in terms of feasibility.
18. Bespoke has produced a 50 per cent developed design with options for staging of project delivery if required. Staff presented this to the local board at the April 2024 workshop in which the board advised staff that the design was supported in principle.
19. Subsequent input from PBA and PCC do not support the renderings for artful play, and there is a risk to delivering the project.
20. Separation of the artful play component from the proposed groundworks as two distinct stages of the project allows the health and safety aspects of the site, such as trip hazards to be attended to while development of a satisfactory design for artful play is resolved.

Table 1: approximate budgets required to deliver stage one groundworks only with a staged funding and delivery programme.

Budget allocation	Financial year work programme	Estimated costs
LDI Capex	FY2024/2025	\$438,782
Renewals	FY2024/2025	\$171,603
Total		\$610,385

Stakeholder engagement

21. As requested by the local board, staff have had further discussions with key stakeholders following the approval of the concept plan. Parks and Community Facilities staff, Local Board Services and nominated elected members attended a meeting with PBA and PCC in November 2023 to discuss the desired outcomes envisioned for Heard Park.
22. At this meeting it was agreed that staff and the key stakeholders would compile images related specifically to ideas for artful play to be later discussed with additional key stakeholders, including a member from the Heard family.
23. The second meeting involving staff, elected members and key stakeholders took place on 1 February 2024. Notes from this forum are included as Attachment B – February 2024 Meeting notes from the forum held with key stakeholders. As an action from this meeting staff and the stakeholders collated images of artful play ideas that resonated for the group, shown as Attachment C – Artful play images collated by staff and key stakeholders.
24. The images were subsequently shared with Bespoke and helped to inform the play elements shown in the developed design

Next steps

25. The proposed 2024/2025 financial year work programme will include a project activity for the delivery of the Heard Park redevelopment stage one - complete groundworks.
26. Staff will present the detailed design for stage one project works to the local board at a workshop in July 2024, and proceed to delivery of stage one. The final detailed design including the finalised artful play will be submitted for formal approval thereafter.
27. Staff will continue with resource consenting and project delivery planning as part of the 2023/2024 financial year and 2024/2025 financial year work programmes.
28. Staff will continue to support the Parnell Business Association (PBA) and the Parnell Community Committee (PCC) as they work through the community-led design process and approvals required to enable the development of the artful play component of the design.

Attachments

Attachment A - Heard Park Developed Design

Attachment B – February 2024 Meeting notes from the forum held with key stakeholders

Attachment C – Artful play images collated by staff and key stakeholders

HEARD PARK

Parnell, Auckland

LANDSCAPE CONCEPT DESIGN

APRIL 2024



- LEGEND :**
- 01. Existing retaining wall to be retained in place.
 - 02. Existing stair access and handrails retained in place. Stair nosing retained and new tiles installed to treads and risers.
 - 03. Integrated timber seat element to top of concrete nib wall.
 - 04. Accessible route to rear of park and building access.
 - 05. Proposed garden bed including screening trees.
 - 06. Grass open space.
 - 07. Existing building access stairs and handrail to be retained in place.
 - 08. Proposed expansion of all tree pits including new planting beneath existing trees.
 - 09. Informal access to building along edge of artful play area.
 - 10. Artful play area.
 - 11. Hardscape renewed amongst existing trees.
 - 12. Freestanding timber bench seat elements.









PRECEDENT PROJECTS

HART'S MILL SURROUNDS, ADELAIDE



OHLONE GREENWAY, SAN FRANCISCO



SOUTH PARK, SAN FRANCISCO









APPENDICES



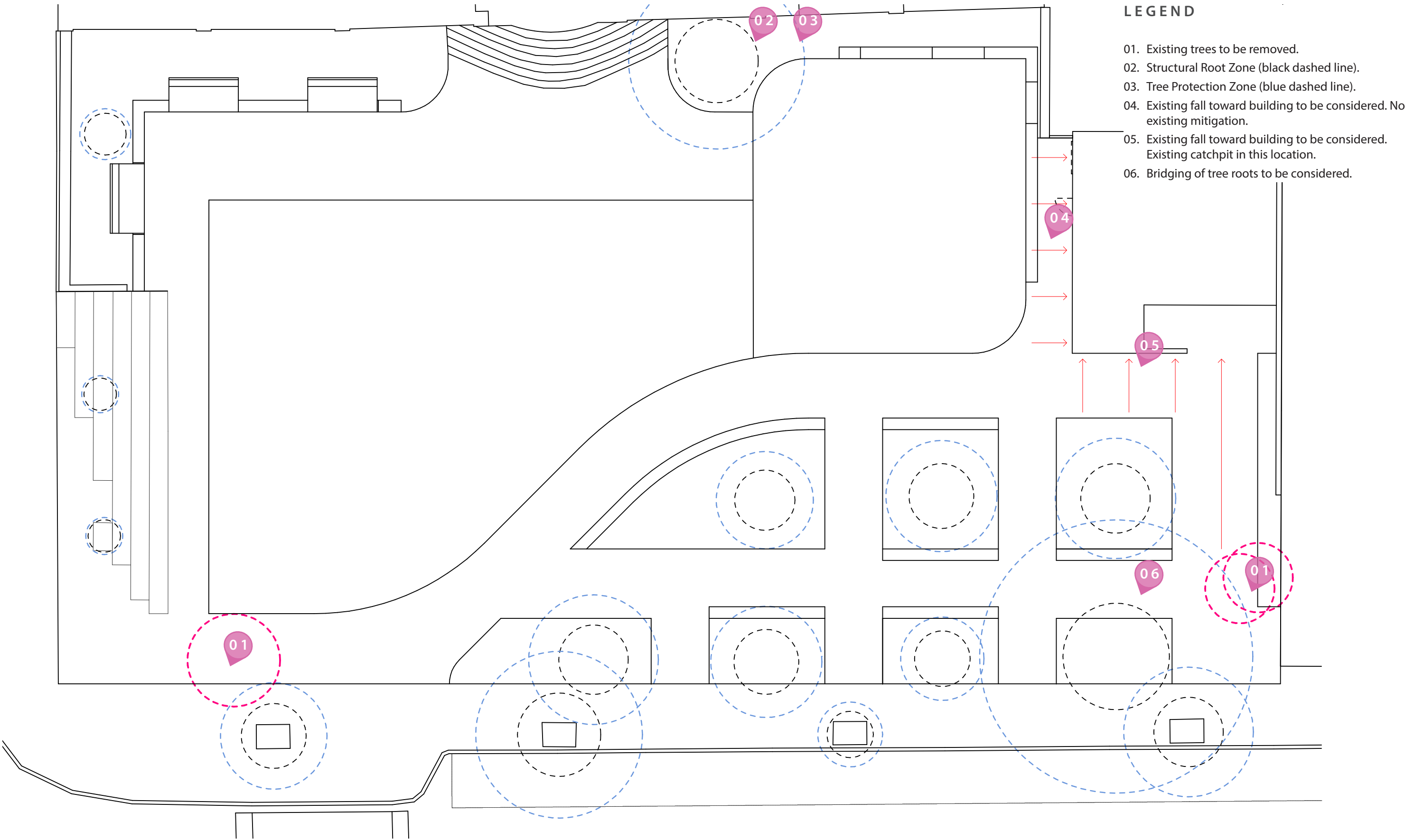

SITE PHOTOS



Meeting Notes

What: Heard Park Civic Space Play – Stakeholder Community Discussion
Where: 192 Parnell Road, Parnell
When: 1 February 2024, 10:00 am – 12:00 pm

Welcome and Introductions

Parnell Business Association

Cheryl Adamson
Callum Baker
Lisa Caughey
Belinda Masfen

Parnell Community Committee

Luke Nuie
Jenni Goulding
Chris Heard
Alison Ward

Waitematā Local Board

Anahera Rawiri
Sarah Trotman

Auckland Council

Cath Duncan – Project Manager, Parks and Community Facilities
Jacqui Fell – Parks and Places Specialist, Parks and Community Facilities
Caroline Teh – Senior Local Board Advisor

Scene Setting/Concept Design Update

The Heard Park concept plan was approved by the Waitematā Local Board in August 2023 (resolution number WTM/2023/131).

- The local board resolution noted the following:
 - additional engagement with external stakeholders, iwi and the community will be undertaken during the resource consent stage
 - a phased approach will need to be considered over subsequent financial years
 - staff will provide the local board with regular progress updates.
- Staff are currently progressing the resource consent and detailed design.
- In November 2023, staff held a meeting with Cheryl and Luke and council staff to discuss the play elements of the concept design. The action for all parties was to submit ideas for 'artful play' (as informed by the approved concept plan) with the intention of sharing these ideas with a wider stakeholder group for further discussion and feedback in early 2024.
- Staff confirmed that there was an indicative budget for the development of Heard Park, and that some of the 'quick wins' of the concept plan had been achieved in the previous financial

year (2022/2023). Staff also advised the group that the local board will face budget constraints in future years, and that progressing the detailed design was a priority for the current year.

Artful Play Discussion and Feedback

Cheryl, Luke and staff have shared a collection of images to inspire ideas and shape the group's discussion on artful play. The presentations were distributed to the group prior to the meeting.

The staff submission on artful play included:

- Contemporary and sculptural play elements
- The intention is to invite group activations and group play for all ages
- Artful play and mosaics
- Building as the backdrop to the play area
- Picture of hanging lollies
- Not keen on formal fence - this would slice up an already small space

There was a roundtable discussion of the images presented. Attendees were invited to speak to their ideas and individual preferences. The conversation captured the following:

Birds on Heard – presented by Lisa Caughey

- Celebrate NZ unique geographical history
- Maori legend of ancient chiefs riding moa
- Lifesize birds to encourage climbing, swinging, balancing, etc.
- Desires something sculptural and unique
- Keen for a tall landmark
- Allow the play space to be a 20-minute playground
- Staff to share this innovative theme with the Auckland Domain Committee

Heard Family Gifting and Legacy and Lollies

- Artful play with a lollies theme – colours and translucence, suggesting but not literally 'lollies'
- Interpretive signage honouring the history of the Heard family and the culture of the place
- Barley sugars

Sculptural play / climbing / swinging

- Ali spoke to her experience with sculptural play design
- Advised that children will play with elements that can be explored and climbed, similar to the dragon at the zoo
- The play elements are also telling a story to visitors – people want to know why something is in the space
- Play elements should be iconic - inviting free play for any age
- Potential to include activation of small items in the park that could be taken wider – sculptural play elements within the park as part of a play trail in Parnell businesses
- Mention of the climbing structure in Wynyard Point, noting the area required for a safe fall area may not be possible
- Explore options for multi-objects around the park
- Retain swinging, with additional swings or basket swing
- Climbing elements must consider safe fall area required

General discussion on play and the site provisions

- Play should be the focus, inviting visitors into Heard Park
- Discussions around civic space provision for play – the provision for play in a civic space and the area on site does not cater for a formalised playground
- Fencing is not supported by council – accessibility issues and barrier implications for visitors
- The façade of the building and the public toilets are not inviting and should be considered as the backdrop to the park and the play area
- Inviting play elements with colour, allow for climbing, touching, exploring

Key Themes from the Discussion

- Celebrate Heard Park as the Heart of Parnell
- A tall landmark/artwork to invite visitors to the space
- Honour the Heard Family
- Interpretive signage could perhaps be incorporated on play items
- Artful play could extend throughout the space (e.g., leaf seating, subtle sound elements, chimes, etc)
- Potential for the activation of small play items in Heard Park across the wider Parnell District (e.g., sculptural items that could be placed in businesses)
- Artful play – colours, mosaics and translucence paying homage to the Heard family but not 'lollies' per se
- Artful play should be low maintenance and long lasting
- Artful play should complement the event installations in the park
- Retain swinging element
- Façade of building and toilet should compliment the park.
- Greenery to camouflage the building (provided for in the concept plan)

Next Steps

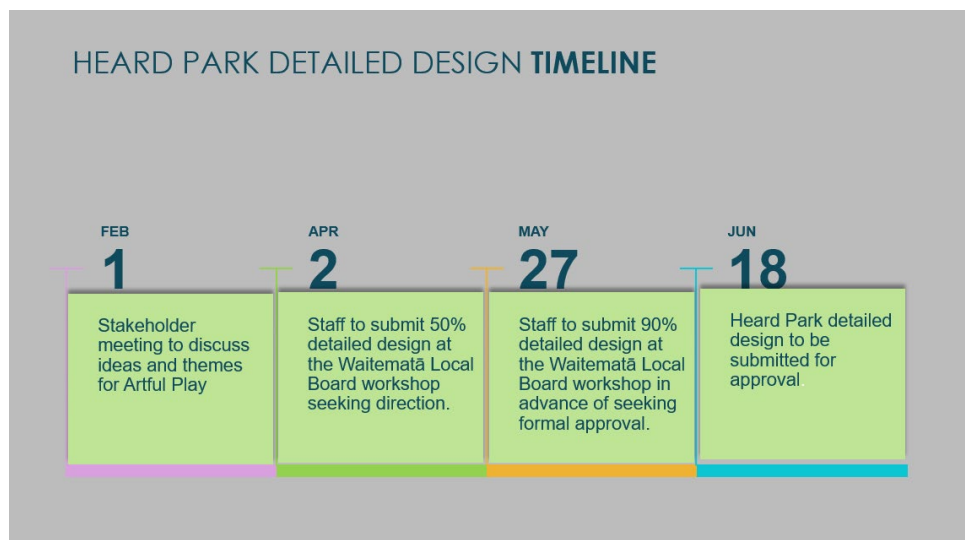

Staff are progressing the detailed design to 50% for presentation to the Waitematā Local Board at a workshop scheduled for 2 April 2024. Local board workshops are not open for public attendance. However, staff will share the workshop material once it can be made publicly available.

As staff prepare for the workshop, staff will be in regular contact with Cheryl to keep stakeholders advised of developments.

Following the local board workshop, staff will seek further feedback from this stakeholder group as the detailed design is finalised.

Staff aim to present the final detailed design for adoption by the local board at the June 2024 business meeting.

Other Business

For any queries, please contact staff.

Cath Duncan – cath.duncan@aucklandcouncil.govt.nz

Jacqui Fell – jacqui.fell@aucklandcouncil.govt.nz

Please note that Caroline Teh will be starting a new role within council and Nick Palmisano will be the local board services liaison.

He can be contacted at nick.palmisano@aucklandcouncil.govt.nz.

Heard Park Artful Play Themes – stakeholder engagement submissions

Cath Duncan – Project Manager, Parks and Community
Facilities



Key Themes From Stakeholder Discussion

- Celebrate Heard Park as the Heart of Parnell
- A landmark/artwork to invite visitors to the space
- Honour the Heard Family
- Interpretive signage could perhaps be incorporated on play items
- Artful play could extend throughout the space (leaf seating, subtle sound elements, chimes, etc)
- Potential for the activation of small play items in Heard Park across the wider Parnell District (sculptural items could be placed in local businesses)
- Colours, mosaics and translucence paying homage to the Heard family but not 'lollies' per se
- Artful play should be low maintenance and long lasting
- Artful play should complement the event installations in the park
- Retain swinging element
- Façade of building and toilet should compliment the park.
- Greenery to camouflage the building (provided for in the concept plan)





Nogushi





Sculptural





Contemporary





Euroflex Balls

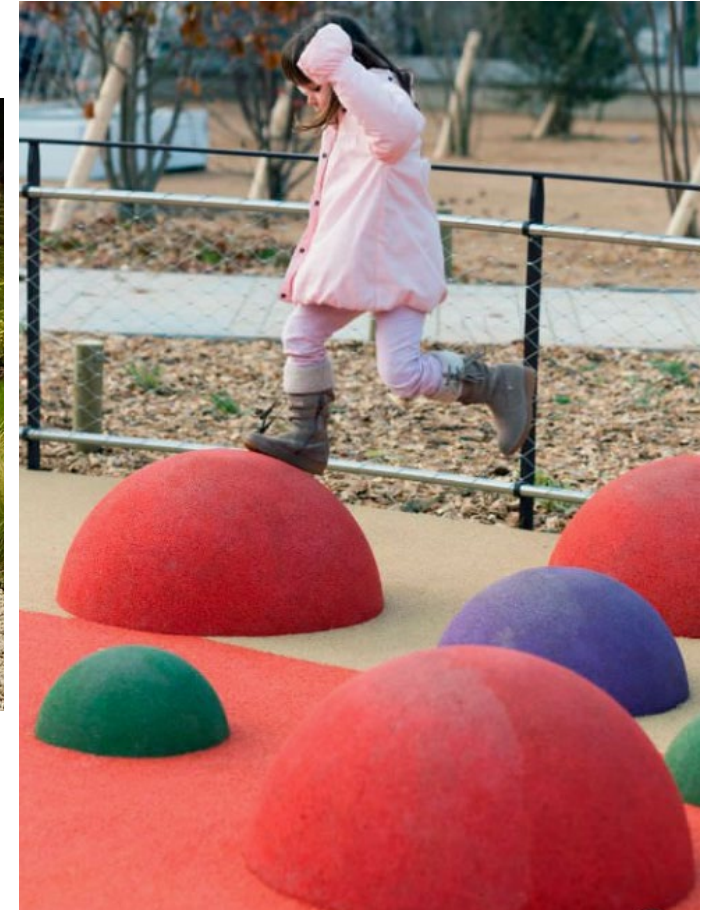



Interactive





Musical/Sound





192 Parnell Road Building Facade



Local board agreement

Waitematā Local Board

May 2024





Key Dates

14 May (workshop) - Finalise 24/25 work programme and performance measures

➔ 28 May (workshop) – discuss draft local board agreement 24/25

11 June (extraordinary business meeting) – adopt local board agreement 24/25

18 June (business meeting) – adopt 24/25 work programme

27 June – Governing Body adopt the LTP 2024-2034

Workshop purpose and background

- To discuss and finalise the ***draft*** local board agreement 2024/2025
- The local board agreement is required as stated by the Local Government (Auckland Council) Act 2009 for each financial year
- The Waitematā local board agreement has been drafted using the local board key priorities consulted on as part of the Long-term Plan as well as workshop discussions with the board on the draft 24/25 work programme and performance measures



Activity areas and proposed key projects

Local Community Services

- Deliver services and programmes that support youth activation, leadership, and wellbeing, particularly in Newmarket.
- Fund the delivery of key events such as the Parnell Festival of Roses and Cultural Play Festival.
- Deliver a new civic space at 254 Ponsonby Road.
- Complete detailed design of Leys Institute remediation and seismic strengthening, and progress physical works.
- Supporting local communities to develop emergency planning and readiness response plans.
- Phased delivery of improvements for Heard Park.



Activity areas and proposed key projects

Local Planning and Development

- Seek opportunities to promote and celebrate heritage places in Waitematā including making digital content and place-based stories more accessible
- Develop programmes that improve perceptions of safety within the City Centre, and our town-centres.
- Support Grey Lynn Business Association with the costs of undertaking a BID establishment ballot



Activity areas and proposed key projects

Local Environmental Management

- Continue important stream restoration projects in Waitītiko/Meola Creek, Waipāruru, and Newmarket/Middleton stream.
- Support our local schools by funding programmes that empower them to take action to improve native biodiversity and water quality and prepare students for common Auckland hazards with climate action education.
- Continue to support the operation of a community bike hub on Queens Wharf which helps communities to make positive choices towards sustainable living.
- Continue funding our Urban Ark Strategic Plan implementation, and Climate Action Activator to support, engage, and upskill our volunteers and community groups to enhance, protect, and restore their local open spaces, forests, and wetlands.



Levels of Service / Performance Measures

Māori Outcomes (new core measure)

Service level statement: We respond to the needs and aspirations of mana whenua and Māori communities

Performance measure: The number of local activities that deliver moderate to high outcomes for Māori as outlined in 'Kia Ora Tamaki Makaurau' (Council's Māori outcomes framework).

How it will be measured: against projects in your local board work programme – **Set baseline** in year one

Asset component condition measures (updated)

The percentage of local community facility **asset** components that are **not** in poor or very poor condition

The percentage of local open space asset components that are **not** in poor or very poor condition

Urban Ngahere

Target now included of 73 trees planted under the Urban Ngahere programme





Next steps

LBA approved in extraordinary
business meeting on 11 June

