

TO Kath Coombes, Acting Manager Planning – Regional, North, West & Islands

FROM Chris Khouri, Policy Planner, Regional, North, West & Islands



DATE 28 April 2026

SUBJECT Update requested to the Auckland Unitary Plan (Operative in Part 2016) (AUP)



I request an update to the AUP as outlined below:

Reason for update	RMA Section 182 Removal of designation confirmed
Chapter(s)	Chapter K Designations Watercare Services Limited – North and West Auckland Unitary Plan GIS viewer
Designation only	
Designation #9352	Silverdale Reservoir (Wainui Road)
Locations:	105 Wainui Road, Silverdale
Lapse Date	Given effect to (i.e. no lapse date)
Purpose	Water supply services – reservoir and associated structures.
Changes to text (shown in underline and strikethrough)	Removal of designation from Chapter K Designations.
Changes to diagrams	No changes required.
Changes to spatial data	Removal of Designation 9352 from AUP GIS viewer – Unitary Plan Layer – Designations.
Attachments	<ul style="list-style-type: none"> Attachment 1: s182 Removal of Designation 9352 Report Attachment 2: Updated Watercare Services North West Schedule and conditions (Strikethrough) Attachment 3: Updated Watercare Services North West Schedule (clean) AUP GIS Viewer (Before/After)

Maps prepared by: Mitesh Bhula Geospatial Specialist	Text Entered by: Bronnie Styles Planning Technician
Signature: 	Signature: 

Prepared by: Chris Khouri Policy Planner	Reviewed by: Peter Vari Team Leader
Signature: 	Signature: 
Authorised by: Kath Coombes Acting Manager Planning – Regional, North, West & Islands	
Signature: 	

Attachment A
s182 Auckland Council Report

Removal of a designation under section 182 of the Resource Management Act 1991



To: Peter Vari, Team Leader, Regional, North, West and Islands Planning Unit

From: Chris Khouri, Policy Planner, Regional, North, West and Islands Planning Unit

Date: 24 April 2026

Subject:

Removal of Designation 9352 Silverdale Reservoir (Wainui Road) in the Auckland Unitary Plan

Summary

Auckland Council has received a request from Watercare Services Limited under section 182 of the Resource Management Act 1991 (RMA), dated 15 April 2026, to remove in full Designation 9352 Silverdale Reservoir (Wainui Road).

A section 182(1) request is required to uplift the existing designation in full, from land which has been deemed surplus by Watercare Services Limited.

Auckland Council, as the territorial authority, is required to amend its district plan, without using the process in Schedule 1, as soon as reasonably practicable after receiving a Section 182 request unless it considers that the effect of the removal of part of the designation on the remaining designation is more than minor.

It is recommended that the removal be accepted.

Recommendation

1. That the section 182 request from Watercare Services Limited for the removal of Designation 9352 Silverdale Reservoir (Wainui Road) in the Auckland Unitary Plan be **accepted** for the following reasons:
 - The Requiring Authority considers the designation to be excess to requirements, all infrastructure within this parcel has been demoted and the land is not owned by the Requiring Authority.
2. That Designation 9352 Silverdale Reservoir (Wainui Road) be removed, as soon as reasonably practicable, in the Designation overlay and Chapter K Designations where the text needs to be amended in the Auckland Unitary Plan.

1. Description

1.1. References

Designation number	9352 Silverdale Reservoir (Wainui Road)
Lodgement date:	15 April 2026
Requiring authority:	Watercare Services Limited
Reporting officer:	Chris Khouri
Site address:	105 Wainui Road, Silverdale Pt DP 9642, Pt Allot 334 Psh Of Waiwera DP 9642
UP Zoning:	Residential – Large Lot

2.0 Background

2.1 Details of designation

The purpose of Designation 9352 Silverdale Reservoir (Wainui Road) is for water supply purposes – reservoir and associated structures.

Designation 9352 is a rollover designation (Designation 135, Auckland Council District Plan (Rodney Section) 2011). Watercare has advised that they inherited the 'out of service' asset from Rodney District Council in November 2010, following the creation of Auckland Council. An assessment concluded that it was deemed to be surplus to future water supply purposes in early 2025 and Watercare commissioned the reservoir to be demolished and cap the pipes at the boundary with no assets left on the property. The property (105 Wainui Road, Silverdale) was later sold in August 2025.

Furthermore, Watercare advises that the new owner of the property wishes to build a house on the site and the existing designation is restricting them from obtaining consent and this process will resolve in a satisfactory outcome for the landowner.

2.2 Land affected by removal

The designation is currently shown in the AUP maps as follows:

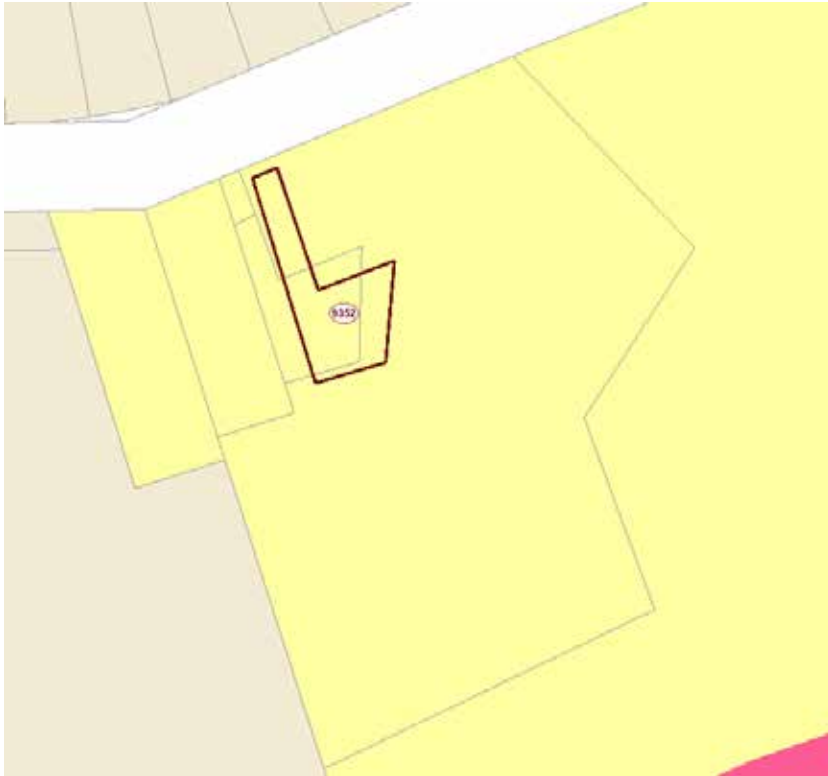

Figure 1: Designation and underlying zoning (Residential – Large Lot zone) of subject site



Figure 2: Aerial photograph of designation site

The site is also subject to:

- Overlay
 - Natural Resources: Significant Ecological Areas Overlay - SEA_T_2180, Terrestrial
- Controls
 - Macroinvertebrate Community Index – Rural
 - Stormwater Management Area Control - SILVERDALE NORTH 1, Flow 1
 - Stormwater Management Area Control - SILVERDALE SOUTH, Flow 1

Additionally, it appears that a mapping inaccuracy has inadvertently led to including the adjoining property (103 Wainui Road) within this designation on the AUP map viewer (as shown in Figures 1 & 2 above) and which Council's Geospatial team shared that this occurred during a previous GIS mapping update. This will be removed as part of this process.

2.3 Delegated authority to consider alterations to designations

The Team Leader Planning - Regional, North, West and Islands (Plans and Places Tier 5) has delegated authority, in accordance with Schedule 2A of the Auckland Council Delegations: Chief Executive Officer (updated November 2025), to exercise the Council's functions, powers, duties and discretions under the Resource Management Act 1991 in relation to Section 182 to approve a removal of a designation.

The section 182 request to remove the designation can therefore be considered by the Team Leader Planning - Regional, North, West and Islands (Plans and Places Tier 5) and accepted or declined.

2.4 Relevant Statutory Provisions

Section 182 of the RMA allows a requiring authority to remove a designation or part of a designation if it no longer wants it. This section also applies to a notice by a territorial authority, to withdraw its own designation or part of a designation within its own district.

Section 182(2) states that as soon as reasonably practicable the territorial authority shall, without using the process in Schedule 1, amend its district plan accordingly. If the territorial authority considers that the effect of the removal of part of a designation on the remaining designation is more than minor, it may, within 20 working days of receipt of a section 182 notice, decline to remove that part of the designation.

It is considered that Watercare Services Limited has provided sufficient justification for the removal of Designation 9352 Silverdale Reservoir (Wainui Road) as this land has been deemed surplus by the Requiring Authority and has been sold to a new owner.

3.0 Recommendation

That pursuant to Section 182 of the Resource Management Act 1991 that the removal of Designation 9352 Silverdale Reservoir (Wainui Road) be **accepted** and the Auckland Unitary Plan Operative in part designation overlay and text in Chapter K Designations be amended accordingly.

Prepared by: Chris Khouri
Policy Planner
Planning - Regional, North,
West and Islands

Accepted: Peter Vari
Team Leader
Planning - Regional, North,
West and Islands

Signature:



Signature:



Date: 28 April 2026

SCHEDULE OF ATTACHMENTS:

- Attachment A:** Watercare Services Limited s182 Notice of Removal
Attachment B: Watercare Services Limited letter to property owner (105 Wainui Road, Silverdale)

Notice of Removal of Designation 9352 Silverdale Reservoir (Wainui Road)

April 2026



Ki te ora te wai, Ka ora te whenua, Ka ora te tangata

When the water is healthy, the land and people are healthy



Designation Alteration Form 23

By Watercare Services Limited for notice of removal in part of designation pursuant to Section 182(1) of the Resource Management Act 1991.

To: Auckland Council
Private Bag 92300
Victoria Street West,
Auckland, 1142

From: Watercare Services Limited
Private Bag 92521
Victoria Street West
Auckland 1142

Pursuant to Section 182(1) of the Resource Management Act 1991 Watercare Services Limited gives notice that it no longer requires the following designation:

Watercare Services Limited (Watercare) seeks removal of Designation 9352—for Silverdale Reservoir (Wainui Road)—included in the Auckland Unitary Plan (Operative in Part) with an approximate area of 660m².

The existing layout of the designation is shown in **Attachment A**. The designation is described in **Table 1** below:

Table 1 – Existing Designation within AUP(OP)

Designation Number:	9352 Silverdale Reservoir (Wainui Road)
Requiring Authority:	Watercare Services Ltd
Location:	105 Wainui Road Silverdale Auckland 0992
Rollover Designation:	Yes
Legacy Reference:	Designation 135, Auckland Council District Plan (Rodney Section) 2011
Lapse Date:	Given effect to (i.e., no lapse date)
Purpose:	Water supply purposes - reservoir and associated structures

The designation is requested to be removed from 105 Wainui Road Silverdale Auckland 0992 as Watercare considers the designation to be excess to requirement. All infrastructure within this parcel has been demoted, and the land is not owned by Watercare. The subject designation to be removed is shown on the plan in **Attachment B**. There is no designation condition associated with Designation 9352 within the Auckland Unitary Plan.

Pursuant to Section 182(1)(b) Watercare has also provided notice to the property owners.

Watercare seeks removal of this designation from the AUP(OP) Geomaps Designation layer and Chapter K Designations, Schedule, and Designations.

Watercare requests the Council to amend the Auckland Unitary Plan accordingly as required by Section 182 of the RMA.

Watercare Services Limited attaches the following information to assist with this notice.

- Attachment A – Existing Designation 9352 under Auckland Unitary Plan (Operative in Part)
- Attachment B – Proposed Designation Removal
- Attachment C – Record of Title (Supplementary Record Sheet)



Tanvir Bhamji

Resource Consents Manager

Watercare Services Limited

Date: 15/04/2026

Address for service:

Attn: Asgari MasumniaBisheh

Resource Consents Planner

Email: asgari.masumniabisheh@water.co.nz

Mob: +64 21 242 7738

Attachment A – Existing Designation 9352 under Auckland Unitary Plan (Operative in Part)



Figure 1 – Designation 9352 within AUP(OP) at 105 Wainui Road Silverdale (Source: AUP(OP))

Attachment B – Proposed Designation Removal



Figure 2 – Proposed Designation Removal for D9352 (Source: Watercare)

Attachment C – Record of Title (NA88C/700)



**RECORD OF TITLE
UNDER LAND TRANSFER ACT 2017
FREEHOLD
Search Copy**



R. W. Muir
Registrar-General
of Land

Identifier NA88C/700
Land Registration District North Auckland
Date Issued 02 December 1992

Prior References
GN A550226

Estate Fee Simple
Area 660 square metres more or less
Legal Description Part Allotment 334 Parish of Waiwera and
Part Deposited Plan 9642

Registered Owners
Tane Edward Trafford and Emily Jane Wright

Interests
13369884.2 Mortgage to Bank of New Zealand - 26.8.2025 at 11:09 am



Rodney District

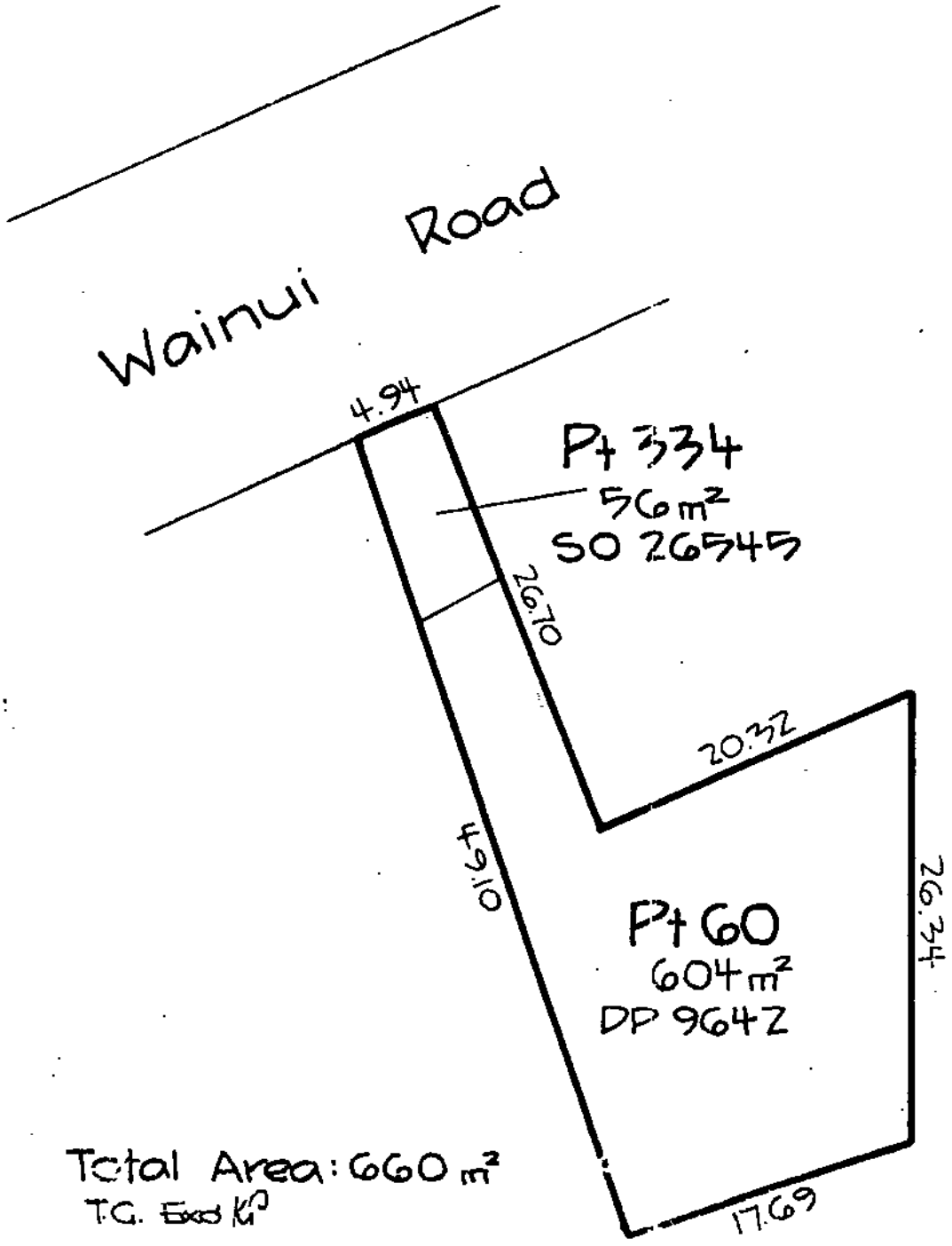

Total Area: 660 m²
T.G. Excl Ki³

15 April 2026

105 Wainui Road
Silverdale 0932

REMOVAL OF DESIGNATION 9352 UNDER s182 OF THE RESOURCE MANAGEMENT ACT 1991

This letter is to advise that as required under s182(1)(b) of the Resource Management Act 1991, Watercare Services Limited is requesting Auckland Council to remove Designation 9352—for Silverdale Reservoir (Wainui Road)—from your property at 105 Wainui Road Silverdale. Please see the images in Appendix A for the change to the designation.

The purpose of this letter is to clarify that the removal of the designation is administrative in nature and will not result in any material or practical effects on the use, development, or enjoyment of your property.

The designation removal does not:

- change the underlying zoning or planning controls that apply to the site
- affect existing use rights or lawful activities on the property
- impose any new restrictions or obligations
- reduce property development potential

The designation removal simply reflects that the designation is no longer required for its original purpose and can be removed without consequence to the landowner.

Should you have any queries regarding this notice, please feel free to contact Asgari MasumniaBisheh via asgari.masumniabisheh@water.co.nz.

Kind Regards



Tanvir Bhamji

Resource Consenting Manager

Watercare Services Limited

Appendix A – Designation Location Plan



Figure 1 and 2 – Proposed Designation Removal (Source: Watercare)

Attachment B

**Watercare Services Limited North South Schedule and
Designation 9352 Silverdale Reservoir (Wainui Road)
(Strikethrough/underscore)**

Designation Schedule - Watercare Services Ltd (1/3)

North and West

Number	Purpose	Location
9300	Water supply purposes - pump station, reservoir and associated structures	2A Sunset Road, Unsworth Heights
9301	Water supply purposes - pump station, future reservoirs and associated structures	Section 1 Survey Office Plan 555200, 53 Schnapper Rock Road, Albany
9302	Water supply purposes - reservoir, pump station and associated structures	106 Pupuke Road, Hilcrest
9303	Water supply Purposes - pump station and associated structures	39 Killarney Street and part of adjoining road reserve, Takapuna
9304	Water Supply purposes - reservoirs and associated structures	83 and 89 Waipa Street, Birkenhead
9305	Water supply purposes - reservoir and associated structures	395 Upper Harbour Drive, Greenhithe
9306	Water supply purposes - reservoir and associated structures	Section 1 Survey Office Plan 557618, 192A Browns Bay Road, Murrays Bay
9307	Water supply purposes - reservoir and associated structures	179 Kowhai Road, Mairangi Bay
9308	Water supply purposes - reservoir, pump station and associated structures	253 Forrest Hill Road, Forrest Hill
9309	Water supply purposes - existing and proposed reservoirs and associated structures	69 Corinthian Drive, Albany
9310	Wastewater purposes - wastewater treatment plant odour buffer area	Rosedale Park, and reserves, roads and motorway in the vicinity of the wastewater treatment plant
9311	Wastewater purposes - wastewater treatment plant and underground route of outfall to Mairangi Bay	Rosedale Road and Upper Harbour Highway, Albany, then via various properties and roads to Mairangi Bay
9312	Water supply purposes - pump station and associated structures	22B Easter Parade, Glen Eden
9313	Water supply purposes - pump station and associated structures	161C Colwill Road, Massey
9314	Water supply purposes - pump station and associated structures	47A Phillip Avenue, Glen Eden
9315	Water supply purposes - reservoir and associated structures	126 McEntee Road, Waitakere
9316	Water supply purposes - reservoir and associated structures	270 Don Buck Road, Massey
9317	Water supply purposes - reservoir and associated structures	893 and 895 Scenic Drive North, Swanson
9318	Water supply purposes - reservoir and associated structures	272A Scenic Drive, Titirangi
9319	Water supply purposes - reservoir and associated structures	19 Bush Road, Waiatarua

9320	Water supply purposes - reservoir and associated structures	1076A Huia Road, Huia
9321	Water supply purposes - water catchment headworks areas	Waitakere Ranges
9322	Water supply purposes - headworks services land	Waitakere Ranges
9323	Water supply purposes - water treatment plant and associated structures	105-121 Christian Road, Swanson and 21 Long Road, Bethells
9324	Water supply purposes - water treatment plants and associated structures	Woodlands Park Road, Manuka Road and Exhibition Drive, Titirangi
9325	Water supply purposes - reservoir and associated structures	88 Sunhill Road, Glen Eden
9326	Water supply purposes - reservoir and associated structures	166-176 Konini Road, Titirangi
9327	Wastewater purposes - storage tanks and associated structures	56 The Concourse, Henderson
9328	Water supply purposes - pump station and associated structures	143 Flanshaw Road, Te Atatu
9329	Water supply purposes - pump station and associated structures	Road Reserve on Pleasant Road / Titirangi Road Corner
9330	Water supply purposes - pump station and associated structures	Totara Road Esplanade Reserve, 9 Kelvin Crescent, Te Atatu Peninsula
9331	Water supply purposes - water treatment plant and associated structures	415A Te Atatu Road, Te Atatu
9332	Water supply purposes - water treatment plant and associated structures	Wood Bay Beach Reserve in the vicinity of 81 Wood Bay Road, Titirangi
9333	Water supply purposes - pump station and associated structures	Road Reserve, adjoining 172A Laingholm Drive, Laingholm
9334	Water supply purposes - pump station and associated structures	97B Fred Taylor Drive, Whenuapai
9335	Water supply purposes - water treatment plant	362 Wayby Valley Road, Wellsford
9336	Water supply purposes - reservoir and associated structures	Worthington Road (Lot 1 DP 57349), Wellsford
9337	Wastewater purposes - wastewater treatment plant	Between State Highway 1 and Rustbrook Road (Lot 3 DP 64870), Wellsford
9338	Withdrawn	
9340	Wastewater purposes - wastewater treatment plant	64 Jones Road, Omaha Flats
9341	Water supply purposes - reservoir and associated structures	20 View Road, Warkworth
9342	Wastewater purposes - wastewater treatment plant	6 Brown Road, Warkworth
9343	Wastewater purposes - wastewater treatment plant	55 and 55A Alnwick Street, Warkworth

9344	Water supply purposes - reservoir and associated structures	James Street, Snells Beach, and adjoining properties (Lots 1 and 2 DP 205704)
9345	Water supply purposes - reservoir and associated structures	32 Tudor Collins Drive, Warkworth
9346	Water supply purposes - water treatment plant	118 Hamilton Road, Warkworth
9347	Wastewater purposes - wastewater treatment plant	Te Whau Creek, Hamilton Road (east of 287 and 309 Hamilton Road), Snells Beach
9348	Wastewater purposes - wastewater treatment plant	Weranui Road, in the vicinity of 135 Weranui Road, Waiwera
9349	Water supply purposes - reservoir and associated structures	1002 Hibiscus Coast Highway, Waiwera
9350	Water supply purposes - reservoir and associated structures	138 West Hoe Heights, Orewa
9352	Water supply purposes - reservoir and associated structures Withdrawn	405 Wainui Road
9353	Water supply purposes - reservoir and associated structures	231 Whangaparaoa Road, Whangaparaoa
9354	Water supply purposes - reservoir and associated structures	104A Wade River Road, Arkles Bay
9355	Water supply purposes - reservoir and associated structures	1170 Whangaparaoa Road, Tindalls Bay
9356	Wastewater purposes - wastewater treatment plant	Kaipara Coast Highway (Sec 50 SO 47244), Helensville
9357	Water supply purposes - dams	215 Mangakura, Kiwitahi and Wishart Roads, Helensville
9358	Water supply purposes - reservoir and associated structures	Wishart Road (Sec 62 BLK XIV Kaipara Surevey District), Helensville
9359	Wastewater purposes - wastewater treatment plant	18 Oraha Road, Huapai
9360	Water supply purposes - water treatment plant	148-162 Motutara Road, Muriwai
9361	Wastewater purposes - exclusion of dwellings in the area surrounding the wastewater treatment plant	Land surrounding the wastewater treatment ponds including 106 Rustybrook Road, 1496 State Highway 1, 133 Wayby Valley Road and Lot 2 DP 171826, Wellsford
9362	Wastewater purposes - wastewater treatment plant	1535 Whangaparaoa Road, Army Bay
9363	Wastewater purposes - exclusion of dwellings in the area surrounding the wastewater treatment plant	Land surrounding the wastewater treatment ponds, Te Whau Creek, Snells Beach (including 287 and 309 Hamilton Road and 120 Hamatana Road)
9364	Wastewater purposes - exclusion of dwellings in the area surrounding the wastewater treatment plant	Land surrounding the wastewater treatment ponds, (including 135 Weranui Road and 12, 45, 83 and 105 Jarvis Road), Waiwera
9366	Water supply purposes - reservoir and associated structures	190 West Hoe Heights, Orewa
9367	Water supply purposes - reservoir and associated Structures (including power supply and telemetry)	2 Lonely Track Road, Glenvar
9368	Water supply purposes - pump station and associated structures	East Coast Road (road reserve) south of Bawden Road, Redvale

9369	Water supply purposes - reservoir and associated structures	125 and 117 Scott Road, Wade Heads (Lot 1 DP 153974 and Lot 1 DP 432769)
9370	Wastewater purposes - pump station, constructed overflow and associated structures	228 Millwater Parkway, Silverdale
9371	Water supply purposes - pump station and associated structures	2-12 Lincoln Park Avenue, Massey
9372	Wastewater purposes	Section 1 and Section 2 SO 467484
9373	Water supply purposes	403 Old North Road, Huapai
9374	Water supply purposes	86 Hudson Road, Warkworth
9375	Wastewater purposes – Northern Interceptor wastewater pipelines, pumping stations, and associated infrastructure.	From 56 The Concourse, Henderson to 4 – 6 Hobsonville Road, West Harbour ; and from 15 The Knoll, Greenhithe to Rosedale Wastewater Treatment Plant
9376	Water supply purposes – pipelines and associated infrastructure	From 114 Scenic Drive, Titirangi to Albany Reservoir, Corinthian Drive, Albany
9377	Water supply and wastewater purposes – pipelines, pumping stations and associated infrastructure	From eastern end Fred Taylor Drive to western end Greenhithe Bridge causeway
9378	Water supply purposes – pump station and associated structures	157 Oteha Valley Road, Fairview Heights
9379	Wastewater purposes – to construct, operate and maintain a pump station, gravity main and associated infrastructure.	32 Mamari Road, 8 Spedding Road, Spedding Road road reserve, 23A Brigham Creek Road, 23-27 Brigham Creek Road, Brigham Creek Road road reserve, 20-22 Brigham Creek Road, 26 Brigham Creek, 28 Brigham Creek Road, Tamiro Road and Roundal Crescent
9380	Wastewater purposes – pump station and associated structures	19 and 21 Kahika Road, Birkdale, R240 Beach Haven Road, Birkenhead (Hellyers Creek Reserve), and road reserve (Kahika Road cul-de-sac)
9381	Water Supply – including abstraction, treatment and storage of water.	3 Audrey Luckens Lane, Helensville, 0800
9382	Wastewater purposes – wastewater treatment plant, disposal and associated structures	3 & 4 Denehurst Drive, Waimauku
9383	Wastewater purposes – pump station and associated structures	R21 Alma Road, Milford (Lot 6 DP 46541)
9384	Wastewater purposes – pump station and associated structures	1 Te Oneroa Way, Long Bay (Lot 98 DP 457552)
9385	Wastewater purposes – pump station and associated structures	161 Brigham Creek Road, Whenuapai (SEC 14 SO 421598)
9386	Water supply purposes, including abstraction, treatment and storage of water at the new Wellsford Water Treatment Plant (WTP).	411 Wayby Valley Road and part of 254 Whangaripo Valley Road, Wellsford, Auckland

9387	Wastewater purposes – administration, maintenance, delivery facilities, pump station and associated structures.	1 Upper Harbour Highway, Rosedale
9388	Water supply purposes - reservoir and associated structures	Christian Road Reserve, adjoining 100 Christian Road, Swanson and 102 Christian Road, Swanson

9352 Silverdale Reservoir (Wainui Road)

Designation Number	9352
Requiring Authority	Watercare Services Ltd
Location	105 Wainui Road, Silverdale
Rollover Designation	Yes
Legacy Reference	Designation 135, Auckland Council District Plan (Rodney Section) 2011
Lapse Date	Given effect to (i.e. no lapse date)

Purpose

Water supply purposes—reservoir and associated structures.

Conditions

No conditions.

Attachments

No attachments.

Attachment C

**Watercare Services Limited North South Schedule and
Designation 9352 Silverdale Reservoir (Wainui Road)
(Clean)**

Designation Schedule - Watercare Services Ltd (1/3)

North and West

Number	Purpose	Location
9300	Water supply purposes - pump station, reservoir and associated structures	2A Sunset Road, Unsworth Heights
9301	Water supply purposes - pump station, future reservoirs and associated structures	Section 1 Survey Office Plan 555200, 53 Schnapper Rock Road, Albany
9302	Water supply purposes - reservoir, pump station and associated structures	106 Pupuke Road, Hilcrest
9303	Water supply Purposes - pump station and associated structures	39 Killarney Street and part of adjoining road reserve, Takapuna
9304	Water Supply purposes - reservoirs and associated structures	83 and 89 Waipa Street, Birkenhead
9305	Water supply purposes - reservoir and associated structures	395 Upper Harbour Drive, Greenhithe
9306	Water supply purposes - reservoir and associated structures	Section 1 Survey Office Plan 557618, 192A Browns Bay Road, Murrays Bay
9307	Water supply purposes - reservoir and associated structures	179 Kowhai Road, Mairangi Bay
9308	Water supply purposes - reservoir, pump station and associated structures	253 Forrest Hill Road, Forrest Hill
9309	Water supply purposes - existing and proposed reservoirs and associated structures	69 Corinthian Drive, Albany
9310	Wastewater purposes - wastewater treatment plant odour buffer area	Rosedale Park, and reserves, roads and motorway in the vicinity of the wastewater treatment plant
9311	Wastewater purposes - wastewater treatment plant and underground route of outfall to Mairangi Bay	Rosedale Road and Upper Harbour Highway, Albany, then via various properties and roads to Mairangi Bay
9312	Water supply purposes - pump station and associated structures	22B Easter Parade, Glen Eden
9313	Water supply purposes - pump station and associated structures	161C Colwill Road, Massey
9314	Water supply purposes - pump station and associated structures	47A Phillip Avenue, Glen Eden
9315	Water supply purposes - reservoir and associated structures	126 McEntee Road, Waitakere
9316	Water supply purposes - reservoir and associated structures	270 Don Buck Road, Massey
9317	Water supply purposes - reservoir and associated structures	893 and 895 Scenic Drive North, Swanson
9318	Water supply purposes - reservoir and associated structures	272A Scenic Drive, Titirangi
9319	Water supply purposes - reservoir and associated structures	19 Bush Road, Waiatarua

9320	Water supply purposes - reservoir and associated structures	1076A Huia Road, Huia
9321	Water supply purposes - water catchment headworks areas	Waitakere Ranges
9322	Water supply purposes - headworks services land	Waitakere Ranges
9323	Water supply purposes - water treatment plant and associated structures	105-121 Christian Road, Swanson and 21 Long Road, Bethells
9324	Water supply purposes - water treatment plants and associated structures	Woodlands Park Road, Manuka Road and Exhibition Drive, Titirangi
9325	Water supply purposes - reservoir and associated structures	88 Sunhill Road, Glen Eden
9326	Water supply purposes - reservoir and associated structures	166-176 Konini Road, Titirangi
9327	Wastewater purposes - storage tanks and associated structures	56 The Concourse, Henderson
9328	Water supply purposes - pump station and associated structures	143 Flanshaw Road, Te Atatu
9329	Water supply purposes - pump station and associated structures	Road Reserve on Pleasant Road / Titirangi Road Corner
9330	Water supply purposes - pump station and associated structures	Totara Road Esplanade Reserve, 9 Kelvin Crescent, Te Atatu Peninsula
9331	Water supply purposes - water treatment plant and associated structures	415A Te Atatu Road, Te Atatu
9332	Water supply purposes - water treatment plant and associated structures	Wood Bay Beach Reserve in the vicinity of 81 Wood Bay Road, Titirangi
9333	Water supply purposes - pump station and associated structures	Road Reserve, adjoining 172A Laingholm Drive, Laingholm
9334	Water supply purposes - pump station and associated structures	97B Fred Taylor Drive, Whenuapai
9335	Water supply purposes - water treatment plant	362 Wayby Valley Road, Wellsford
9336	Water supply purposes - reservoir and associated structures	Worthington Road (Lot 1 DP 57349), Wellsford
9337	Wastewater purposes - wastewater treatment plant	Between State Highway 1 and Rustbrook Road (Lot 3 DP 64870), Wellsford
9338	Withdrawn	
9340	Wastewater purposes - wastewater treatment plant	64 Jones Road, Omaha Flats
9341	Water supply purposes - reservoir and associated structures	20 View Road, Warkworth
9342	Wastewater purposes - wastewater treatment plant	6 Brown Road, Warkworth
9343	Wastewater purposes - wastewater treatment plant	55 and 55A Alnwick Street, Warkworth

9344	Water supply purposes - reservoir and associated structures	James Street, Snells Beach, and adjoining properties (Lots 1 and 2 DP 205704)
9345	Water supply purposes - reservoir and associated structures	32 Tudor Collins Drive, Warkworth
9346	Water supply purposes - water treatment plant	118 Hamilton Road, Warkworth
9347	Wastewater purposes - wastewater treatment plant	Te Whau Creek, Hamilton Road (east of 287 and 309 Hamilton Road), Snells Beach
9348	Wastewater purposes - wastewater treatment plant	Weranui Road, in the vicinity of 135 Weranui Road, Waiwera
9349	Water supply purposes - reservoir and associated structures	1002 Hibiscus Coast Highway, Waiwera
9350	Water supply purposes - reservoir and associated structures	138 West Hoe Heights, Orewa
9352	Withdrawn	
9353	Water supply purposes - reservoir and associated structures	231 Whangaparaoa Road, Whangaparaoa
9354	Water supply purposes - reservoir and associated structures	104A Wade River Road, Arkles Bay
9355	Water supply purposes - reservoir and associated structures	1170 Whangaparaoa Road, Tindalls Bay
9356	Wastewater purposes - wastewater treatment plant	Kaipara Coast Highway (Sec 50 SO 47244), Helensville
9357	Water supply purposes - dams	215 Mangakura, Kiwitahi and Wishart Roads, Helensville
9358	Water supply purposes - reservoir and associated structures	Wishart Road (Sec 62 BLK XIV Kaipara Surevey District), Helensville
9359	Wastewater purposes - wastewater treatment plant	18 Orahia Road, Huapai
9360	Water supply purposes - water treatment plant	148-162 Motutara Road, Muriwai
9361	Wastewater purposes - exclusion of dwellings in the area surrounding the wastewater treatment plant	Land surrounding the wastewater treatment ponds including 106 Rustybrook Road, 1496 State Highway 1, 133 Wayby Valley Road and Lot 2 DP 171826, Wellsford
9362	Wastewater purposes - wastewater treatment plant	1535 Whangaparaoa Road, Army Bay
9363	Wastewater purposes - exclusion of dwellings in the area surrounding the wastewater treatment plant	Land surrounding the wastewater treatment ponds, Te Whau Creek, Snells Beach (including 287 and 309 Hamilton Road and 120 Hamatana Road)
9364	Wastewater purposes - exclusion of dwellings in the area surrounding the wastewater treatment plant	Land surrounding the wastewater treatment ponds, (including 135 Weranui Road and 12, 45, 83 and 105 Jarvis Road), Waiwera
9366	Water supply purposes - reservoir and associated structures	190 West Hoe Heights, Orewa
9367	Water supply purposes - reservoir and associated Structures (including power supply and telemetry)	2 Lonely Track Road, Glenvar
9368	Water supply purposes - pump station and associated structures	East Coast Road (road reserve) south of Bawden Road, Redvale
9369	Water supply purposes - reservoir and associated structures	125 and 117 Scott Road, Wade Heads (Lot 1 DP 153974 and Lot 1 DP 432769)

9370	Wastewater purposes - pump station, constructed overflow and associated structures	228 Millwater Parkway, Silverdale
9371	Water supply purposes - pump station and associated structures	2-12 Lincoln Park Avenue, Massey
9372	Wastewater purposes	Section 1 and Section 2 SO 467484
9373	Water supply purposes	403 Old North Road, Huapai
9374	Water supply purposes	86 Hudson Road, Warkworth
9375	Wastewater purposes – Northern Interceptor wastewater pipelines, pumping stations, and associated infrastructure.	From 56 The Concourse, Henderson to 4 – 6 Hobsonville Road, West Harbour ; and from 15 The Knoll, Greenhithe to Rosedale Wastewater Treatment Plant
9376	Water supply purposes – pipelines and associated infrastructure	From 114 Scenic Drive, Titirangi to Albany Reservoir, Corinthian Drive, Albany
9377	Water supply and wastewater purposes – pipelines, pumping stations and associated infrastructure	From eastern end Fred Taylor Drive to western end Greenhithe Bridge causeway
9378	Water supply purposes – pump station and associated structures	157 Oteha Valley Road, Fairview Heights
9379	Wastewater purposes – to construct, operate and maintain a pump station, gravity main and associated infrastructure.	32 Mamari Road, 8 Spedding Road, Spedding Road road reserve, 23A Brigham Creek Road, 23-27 Brigham Creek Road, Brigham Creek Road road reserve, 20-22 Brigham Creek Road, 26 Brigham Creek, 28 Brigham Creek Road, Tamiro Road and Roundal Crescent
9380	Wastewater purposes – pump station and associated structures	19 and 21 Kahika Road, Birkdale, R240 Beach Haven Road, Birkenhead (Hellyers Creek Reserve), and road reserve (Kahika Road cul-de-sac)
9381	Water Supply – including abstraction, treatment and storage of water.	3 Audrey Luckens Lane, Helensville, 0800
9382	Wastewater purposes – wastewater treatment plant, disposal and associated structures	3 & 4 Denehurst Drive, Waimauku
9383	Wastewater purposes – pump station and associated structures	R21 Alma Road, Milford (Lot 6 DP 46541)
9384	Wastewater purposes – pump station and associated structures	1 Te Oneroa Way, Long Bay (Lot 98 DP 457552)
9385	Wastewater purposes – pump station and associated structures	161 Brigham Creek Road, Whenuapai (SEC 14 SO 421598)
9386	Water supply purposes, including abstraction, treatment and storage of water at the new Wellsford Water Treatment Plant (WTP).	411 Wayby Valley Road and part of 254 Whangaripo Valley Road, Wellsford, Auckland
9387	Wastewater purposes – administration, maintenance, delivery facilities, pump station and associated structures.	1 Upper Harbour Highway, Rosedale

9388	Water supply purposes - reservoir and associated structures	Christian Road Reserve, adjoining 100 Christian Road, Swanson and 102 Christian Road, Swanson
------	---	---

Attachment D
AUP GIS Viewer
Designation 9352 Silverdale Reservoir (Wainui Road)
(Before/After)

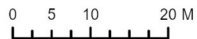
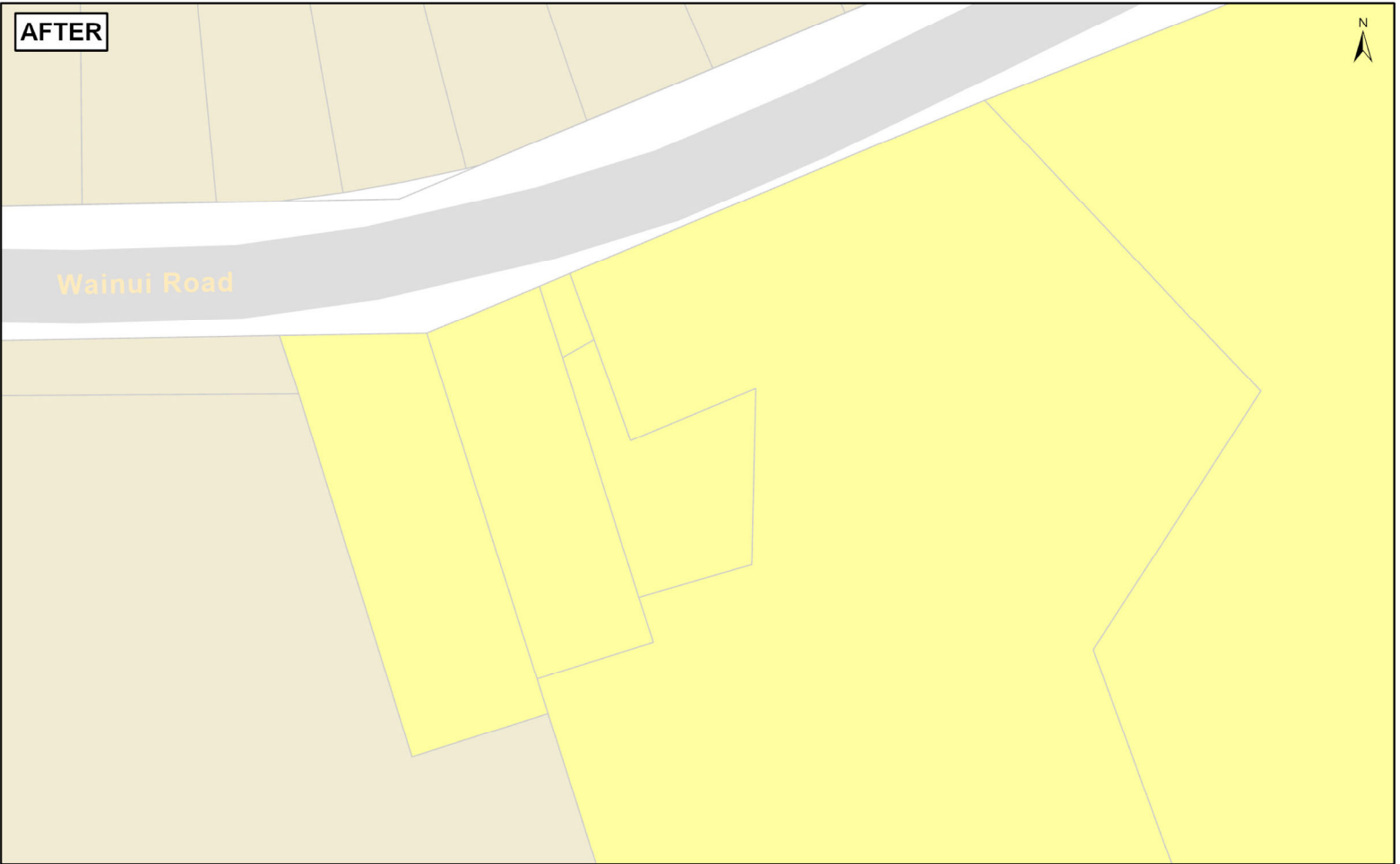
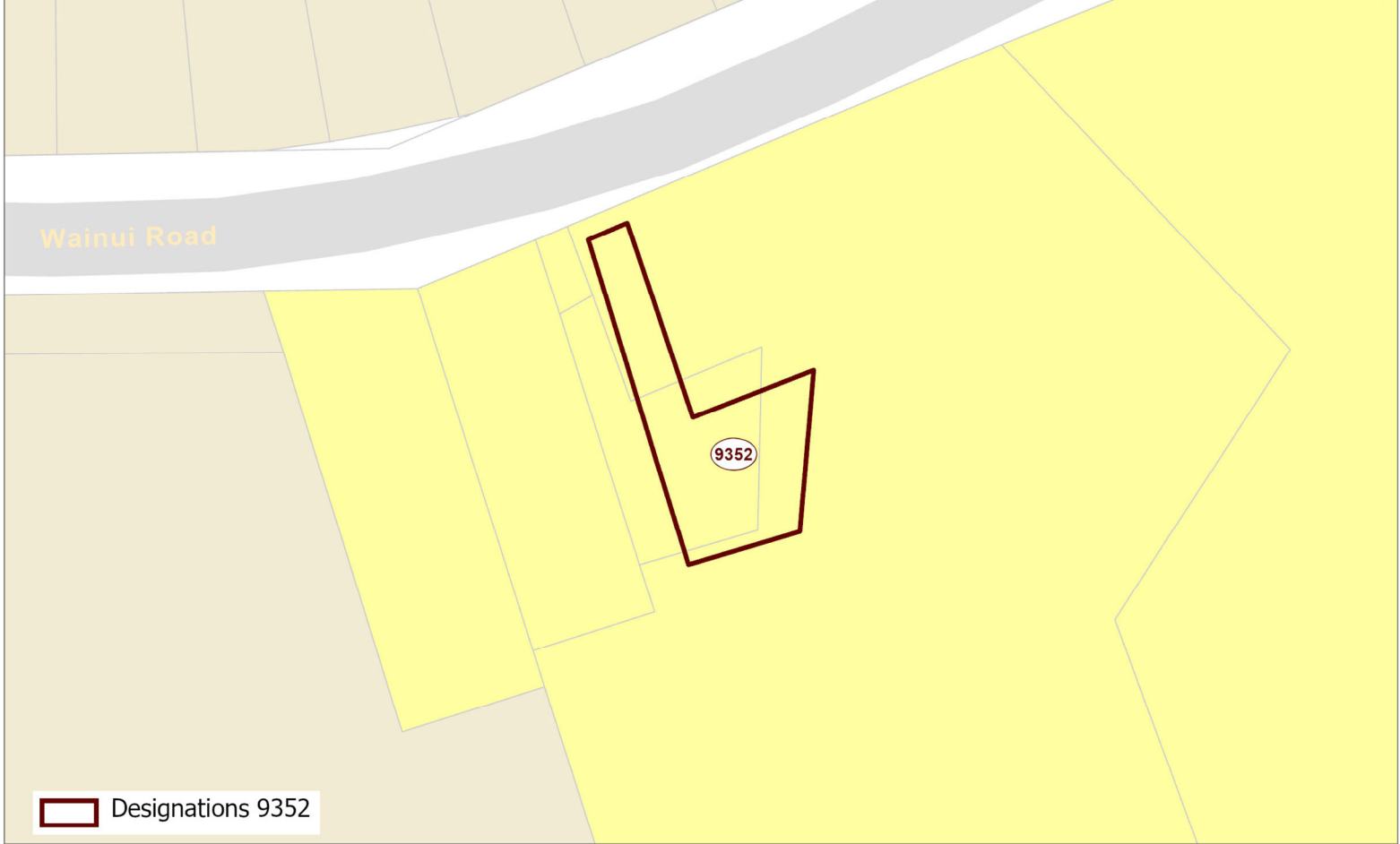

Whilst due care has been taken, Auckland Council gives no warranty as to the accuracy and completeness of any information on this map/plan and accepts no liability for any error, omission or use of the information.

**Section 182 removal of designation 9352
Silverdale Reservoir (Wainui Road) –
105 Wainui Road**



Plans and Places