

# Memo

Date 29.05.2025

To: Kath Coombes Acting Manager Regional, North, West, and Islands, Planning and Resource Consents

From: Leo Archer - Planner

Subject: **Plan Modification: Clause 20A error correction to Auckland Unitary Plan (Operative in Part 2016)**





I seek your approval to correct an error pursuant to clause 20A, schedule 1, Resource Management Act 1991:

*A local authority may amend, without using the process in this schedule, an operative policy statement or plan to correct any minor errors.*

You have delegated authority, as a tier four manager, to make a decision to correct an error under clause 20A. Schedule 2A of the Auckland Council Combined Chief Executives Delegation Register authorises all powers, functions, and duties under RMA's first schedule (except clause 17 which cannot be delegated) to tier four positions.

<b>Provision in AUP or HGI District Plan</b>	Auckland Unitary Plan GIS viewer
<b>Subject site and legal description (if applicable)</b>	19-21 Molley Green Place, Mount Roskill. Comprising of Lot 29 DP 104187 and, Lot 28 DP 104187
<b>Nature of error</b>	There is a discrepancy between the official PDF version of the District Plan and the GIS data for the site. During the original mapping process, updates to the PDF maps and GIS data were handled separately. It appears only the PDF version was updated correctly. As a result, the GIS layer incorrectly includes part of 21 Molley Green Place in the park extent of Molley Green Reserve (Lot 42 DP 104188). This was confirmed as an error by the Geospatial team.
<b>Effect of change</b>	The change will correct an error in the GIS mapping that mistakenly extended the park overlay onto 21 Molley Green Place. The correction will align the GIS mapping with the original PDF District Plan maps. This is a technical correction and reverts zoning from open space to mixed housing suburban. It will not alter the rights of any party and is considered neutral.
<b>Changes required to be made (text and/or in-text diagrams)</b>	This is a GIS mapping correction only.
<b>Changes required to be made (AUP or HGI maps)</b>	Amend the GIS mapping of the park extent for Molley Green Reserve to remove the portion that incorrectly overlaps 21 Molley Green Place.
<b>Attachments</b>	<p><b>Attachment 1:</b> screenshot of the District Plan Map PDF. This is the original extent of Molley Green Reserve.</p> <p><b>Attachment 2:</b> screenshot with 19-21 Molley Green Place that shows the extent of 19-21 Molley Green Place.</p> <p><b>Attachment 3:</b> screenshot of the GIS layer of the District Plan Map that shows the spatial extent of Molley Green Reserve.</p> <p><b>Attachment 4:</b> screenshot of the GIS layer of the District Plan Map that</p>

	<p>shows the spatial extent of 19-21 Molley Green Place.</p> <p><b>Attachment 5:</b> screenshot of the current Zoning with 19-21 Molley Green Place highlighted.</p> <p><b>Attachment 6:</b> Updated GIS viewer</p>
--	---

<b>Maps prepared by:</b> Dean Thompson Geospatial Specialist	<b>Text Entered by:</b> Planning Technician
<b>Signature:</b> 	<b>Signature:</b> N/A
<b>Prepared by:</b> Leo Archer Planner	<b>Reviewed by:</b> Eryn Shields Team Leader
<b>Signature:</b> 	<b>Signature:</b> 
<b>Decision:</b> I agree/disagree to correct the error under clause 20A, schedule 1, RMA 1991 using my delegated authority  Kath Coombes Acting Manager Regional, North, West, and Islands, Planning and Resource Consents  Date: 12 June 2025	
<b>Signature:</b> 	

**Attachment 1:** Screenshot of the District Plan Map PDF. This is the original extent of Molley Green Reserve.

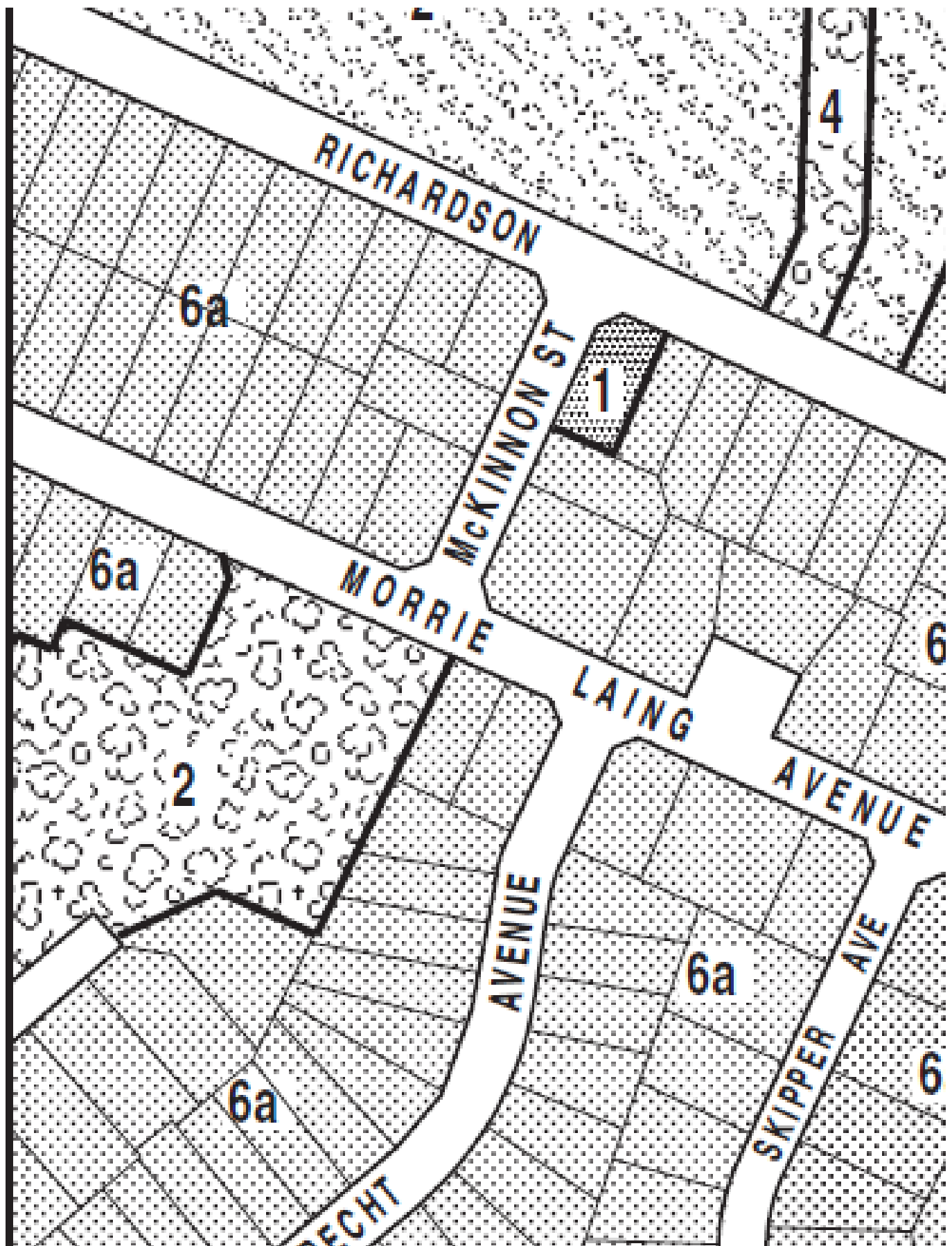

**Attachment 2:** Screenshot with 19-21  
Molley Green Place that shows the extent  
of 19-21 Molley Green Place.

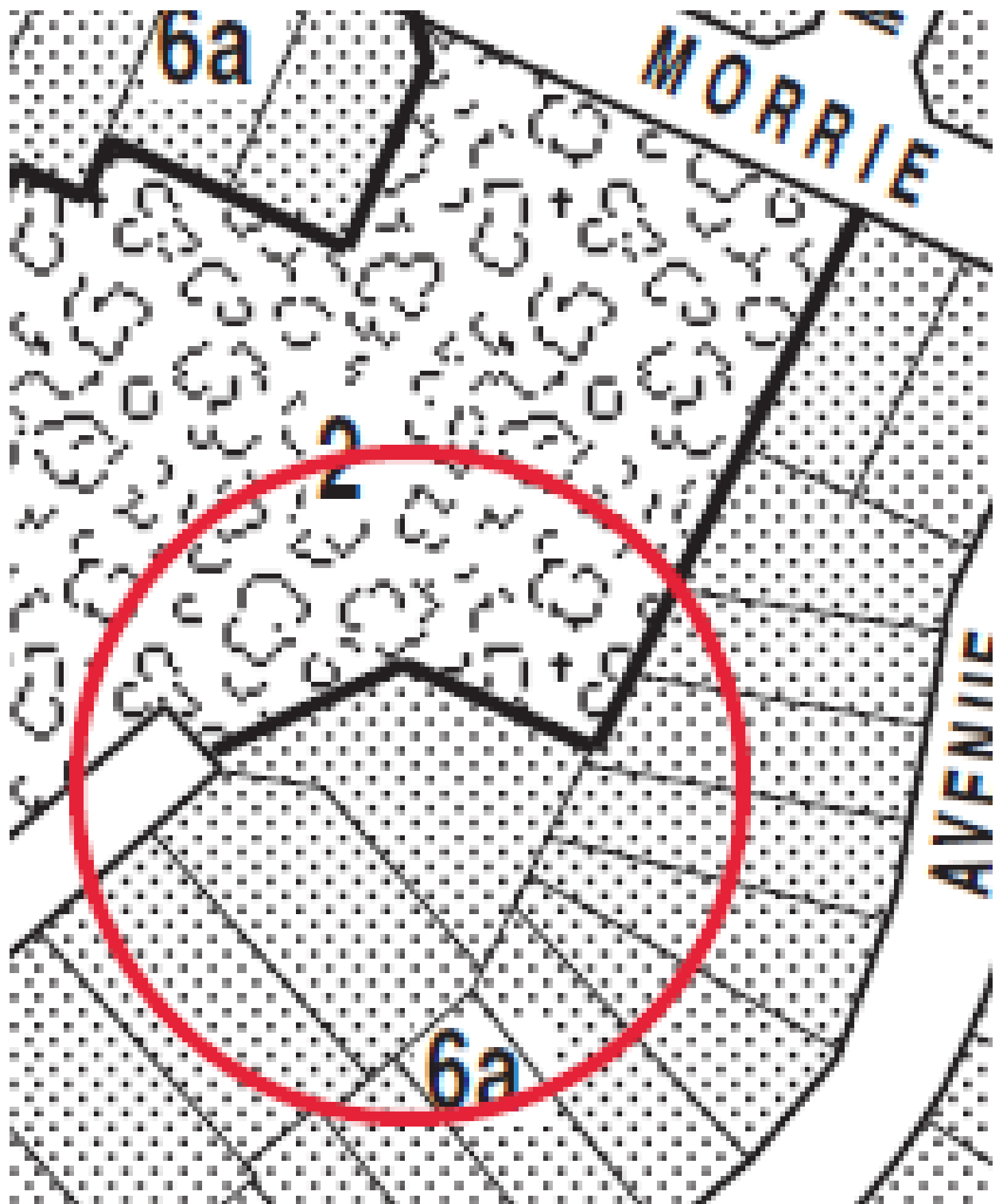

**Attachment 3:** Screenshot of the GIS layer of the District Plan Map that shows the spatial extent of Molley Green Reserve.

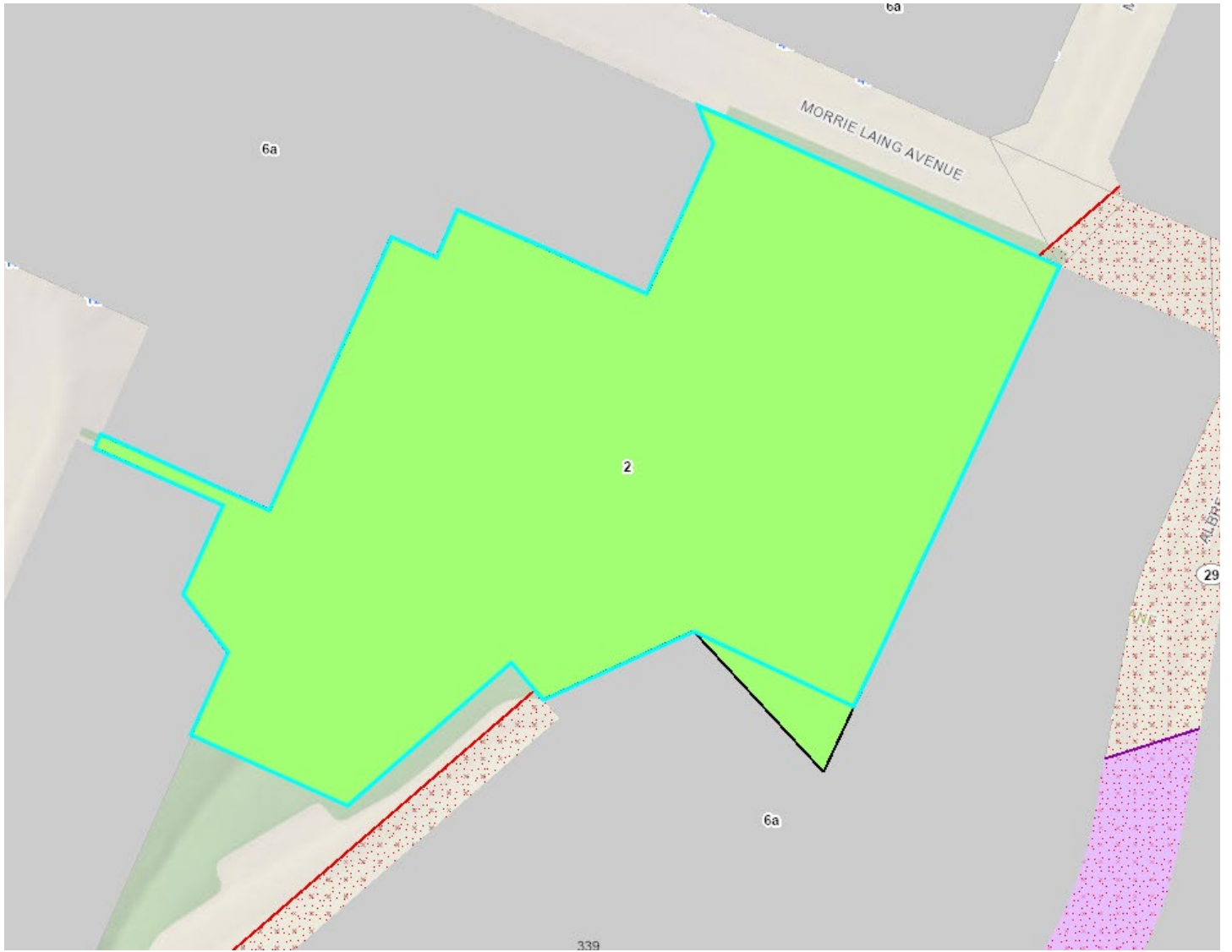



**Attachment 4:** Screenshot of the GIS layer of the District Plan Map that shows the spatial extent of 19-21 Molley Green Place.

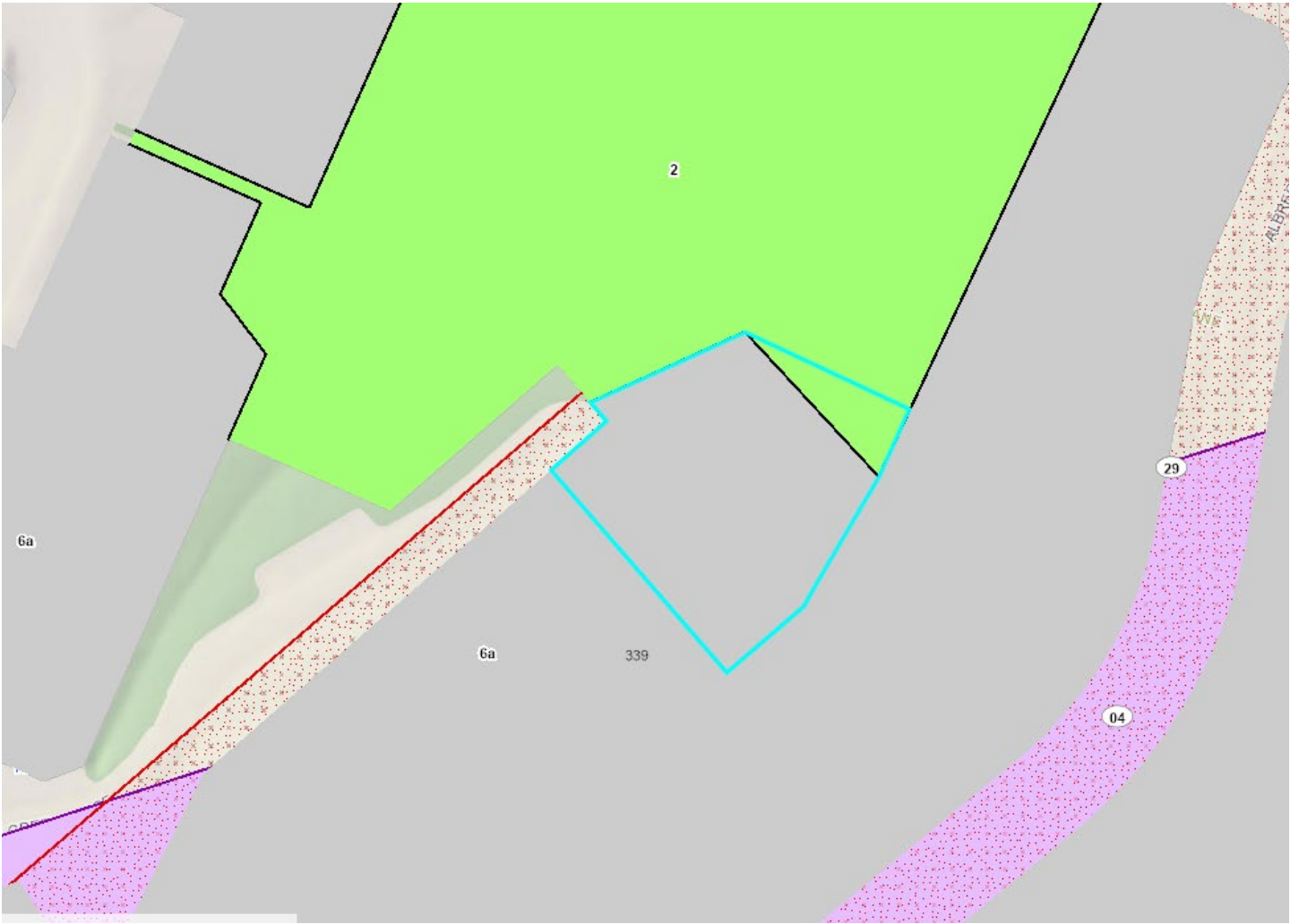

**Attachment 5: Screenshot of the current  
Zoning with 19-21 Molley Green Place  
highlighted**

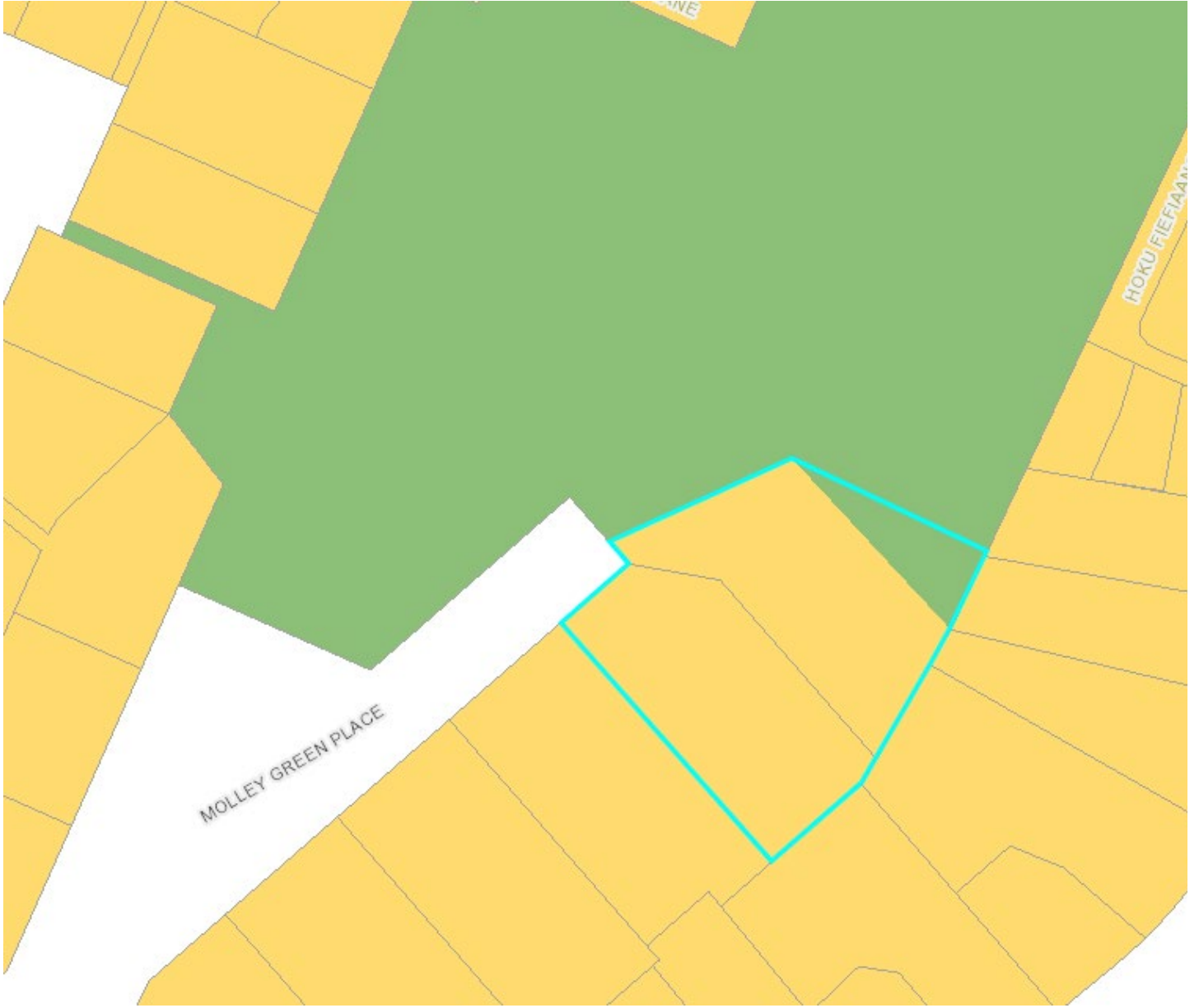

## **Attachment 6: updated GIS viewer**

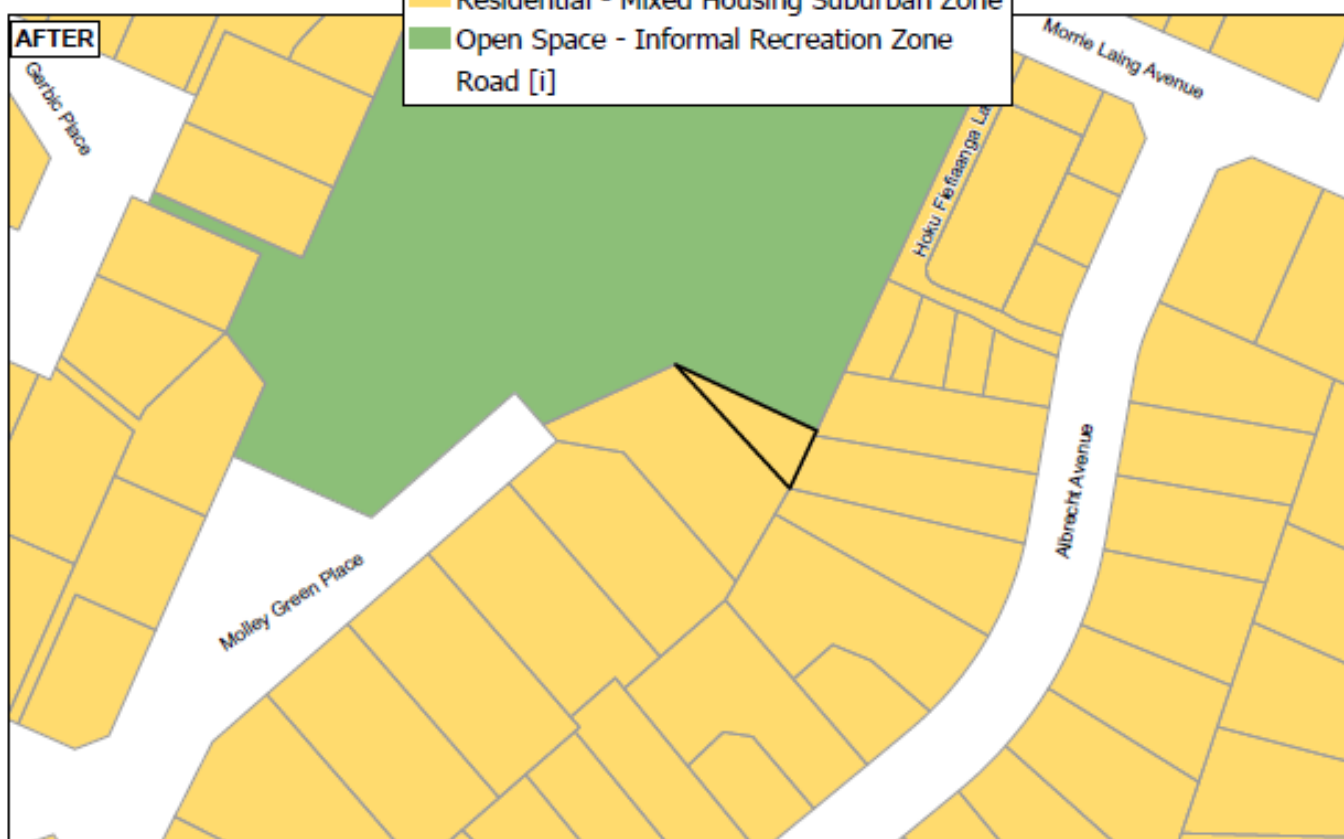
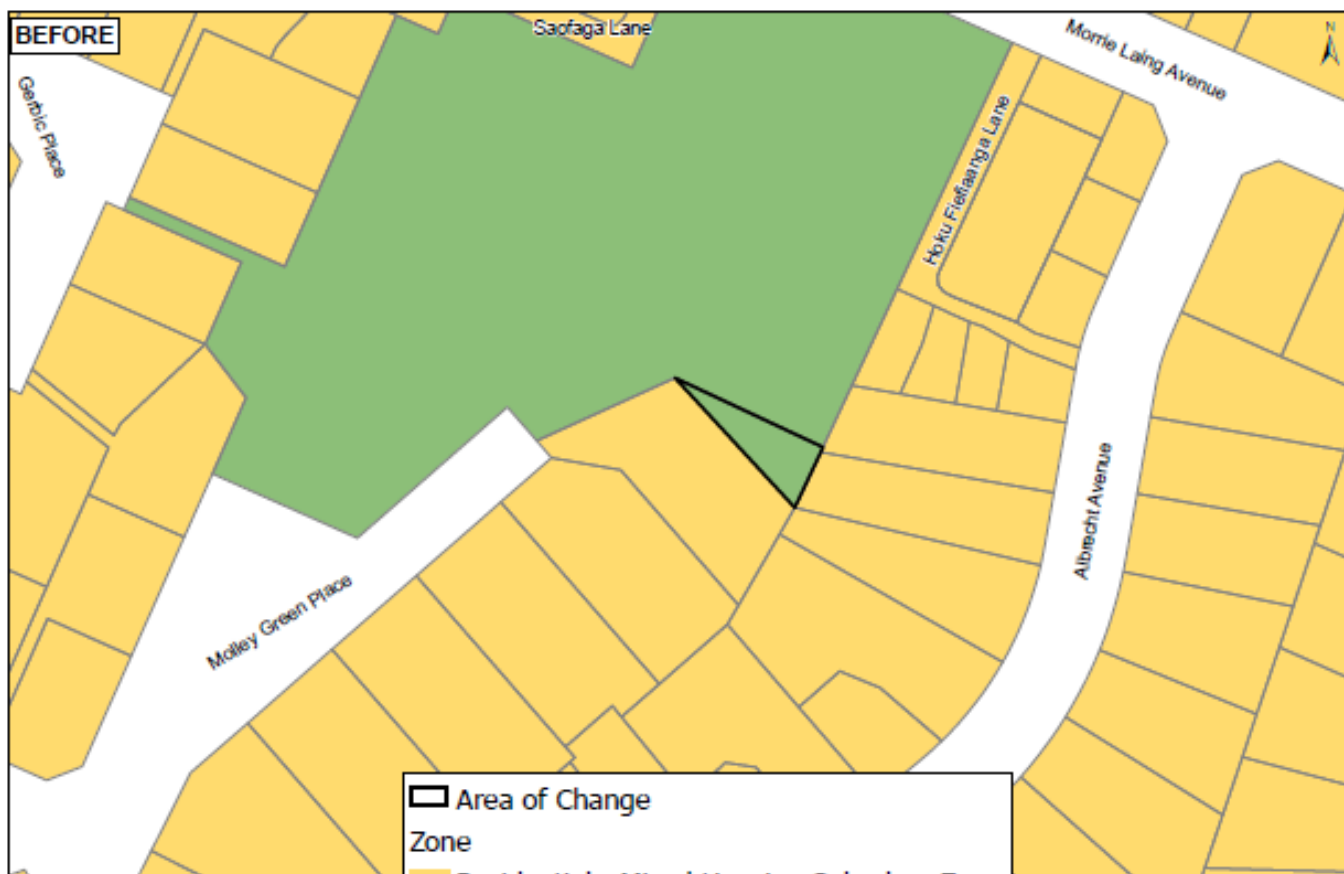

0 10 20 40 Meters

Whilst due care has been taken, Auckland Council gives no warranty as to the accuracy and completeness of any information on this map/plan and accepts no liability for any error, omission or use of the information.

Date: 26/05/2025

## Clause 20a - 21 Molley Green Place, Mount Roskill