



**Project  
update**



# Ambrico and Clinker Place stormwater upgrade

Auckland Council's Healthy Waters department is working to significantly improve the stormwater network in the area, future-proofing it for new developments. We are installing a new stormwater pipe that will serve the upcoming Clinker Place special housing area in New Lynn, creating new homes for Aucklanders.

The project was granted resource consent in August but has not yet commenced due to delays caused by Auckland's Level 4 lockdown. We can safely begin work under the new COVID-19 traffic light system and will be starting construction in late February 2022, with completion expected by mid-2023.

## Project plan recap

A new stormwater pipe will run underground for approximately 550m from the Clinker Place development site in Rankin Ave, via Ambrico Place to a new outfall in Manawa Wetland Reserve. The trenchless methodology will use a Tunnel Boring Machine (TBM), allowing us to reduce disruption to the public.

Three main site areas will be established to support the installation of the three shafts required, these will be located at:

- Shaft 1 - Melview Place, adjacent to the Manawa Wetland Reserve and opposite 10 Ambrico Place.
- Shaft 2 - within the road reserve at 5 Ambrico Place (known as Ambrico Reserve).
- Shaft 3 - within the Clinker Place development site, accessed from 8 Rankin Avenue.

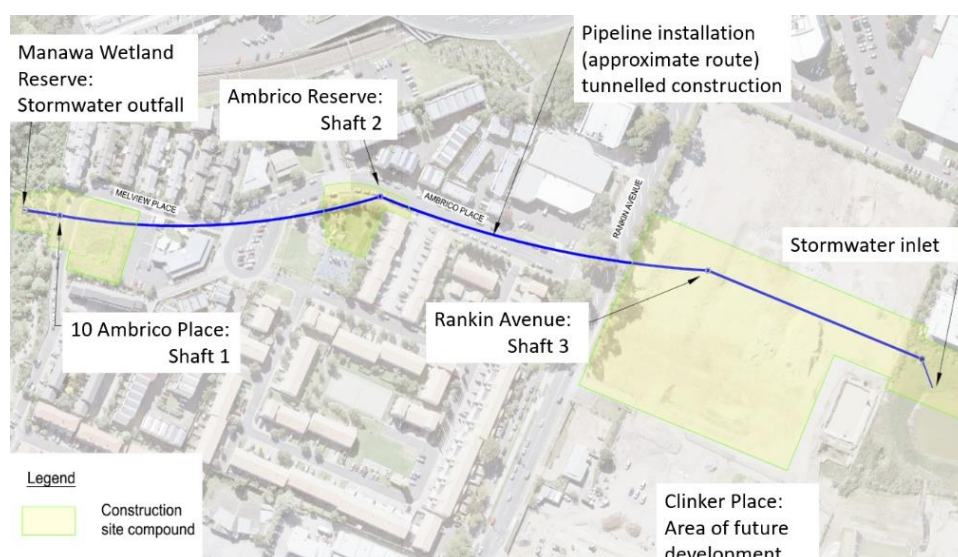

The shafts will be used to launch and retrieve the TBM. The Rankin Avenue site will be used as the main construction staging area.

## What to expect

Our contractors, Abergeldie Complex Infrastructure Limited, will begin by establishing the sites for shaft 2 and 3. These areas will be securely fenced off from the public.

Once construction of the two shafts is completed, the TBM will begin tunnelling the 200m from the Rankin Avenue site to Ambrico Reserve. During this time, we will establish the site for shaft 1 in preparation for the second stage of tunnelling.

When the TBM has reached the Ambrico Reserve shaft, it will be repositioned before it continues tunnelling for the remaining 200m to Melview Place.

All areas of the road and reserve will be reinstated upon completion of the project.

## How will this affect you?

Approximately 40 per cent of Ambrico Reserve will be closed to the public. This will not affect the playground.

Construction hours will be **Monday to Friday, 7am-6pm**. During work hours, there will be some construction noise, large truck movements, vibrations and possibly dust. Noise, dust and vibration will be closely monitored to ensure they remain within required limits. Large truck movements will be kept to a minimum to reduce disruption.

A traffic management plan has been established. The parking shown in red will be temporarily unavailable around Ambrico Reserve, allowing us to maintain two lanes of traffic throughout the project. We will contact you in advance if we need to remove the parking shown in orange.

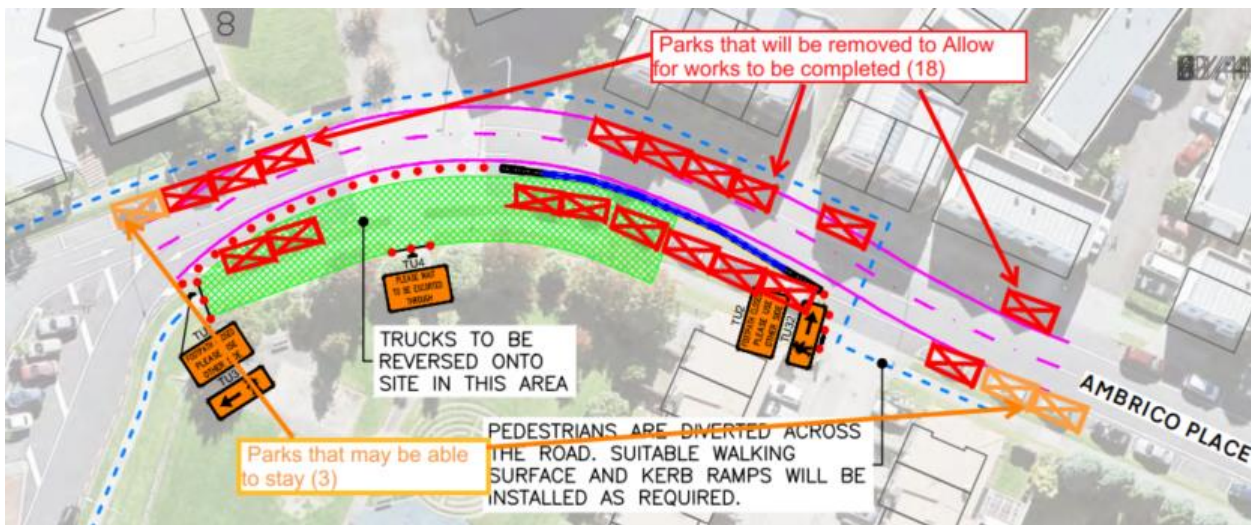

Our contractors will maintain health and safety measures at the highest level with strict hygiene measures and social distancing as advised by the government's COVID-19 guidelines.

## Community activities

We hope to deliver activities during the construction period. Under the current COVID-19 Framework restrictions we are unable to hold any events at this time. As we move through the traffic light system, we will re-evaluate the possibility of community events and keep you informed.



**Need help?**



**Visit: [aucklandcouncil.govt.nz/clinkerplacehw](https://aucklandcouncil.govt.nz/clinkerplacehw)**



**Phone: 09 301 0101**



**Email: [clinkerplaceHW@aucklandcouncil.govt.nz](mailto:clinkerplaceHW@aucklandcouncil.govt.nz)**