



View Statutory Action

Parcel Part Allotment 31 Suburbs of Mangere
Current Purpose Quarry Reserve

Parcel ID 5131429
Parcel Status Current

Statutory Action	Type	Recorded	Action	Status
New Zealand Gazette 1893 p 345	Gazette Notice	04/04/2002	Create	Current

Statute
Purpose Quarry Reserve
Name
Comments

*** End of Report ***



View Statutory Action

Parcel Crown Land Survey Office Plan 30779
Current Purpose Crown Land Reserved from Sale (Marginal Strip)

Parcel ID 4968888
Parcel Status Current

Statutory Action	Type	Recorded	Action	Status
Sec 58 Land Act 1948	Other Statutory actions	04/04/2002	Create	Current

Statute
Purpose Crown Land Reserved from Sale (Marginal Strip)
Name
Comments

*** End of Report ***

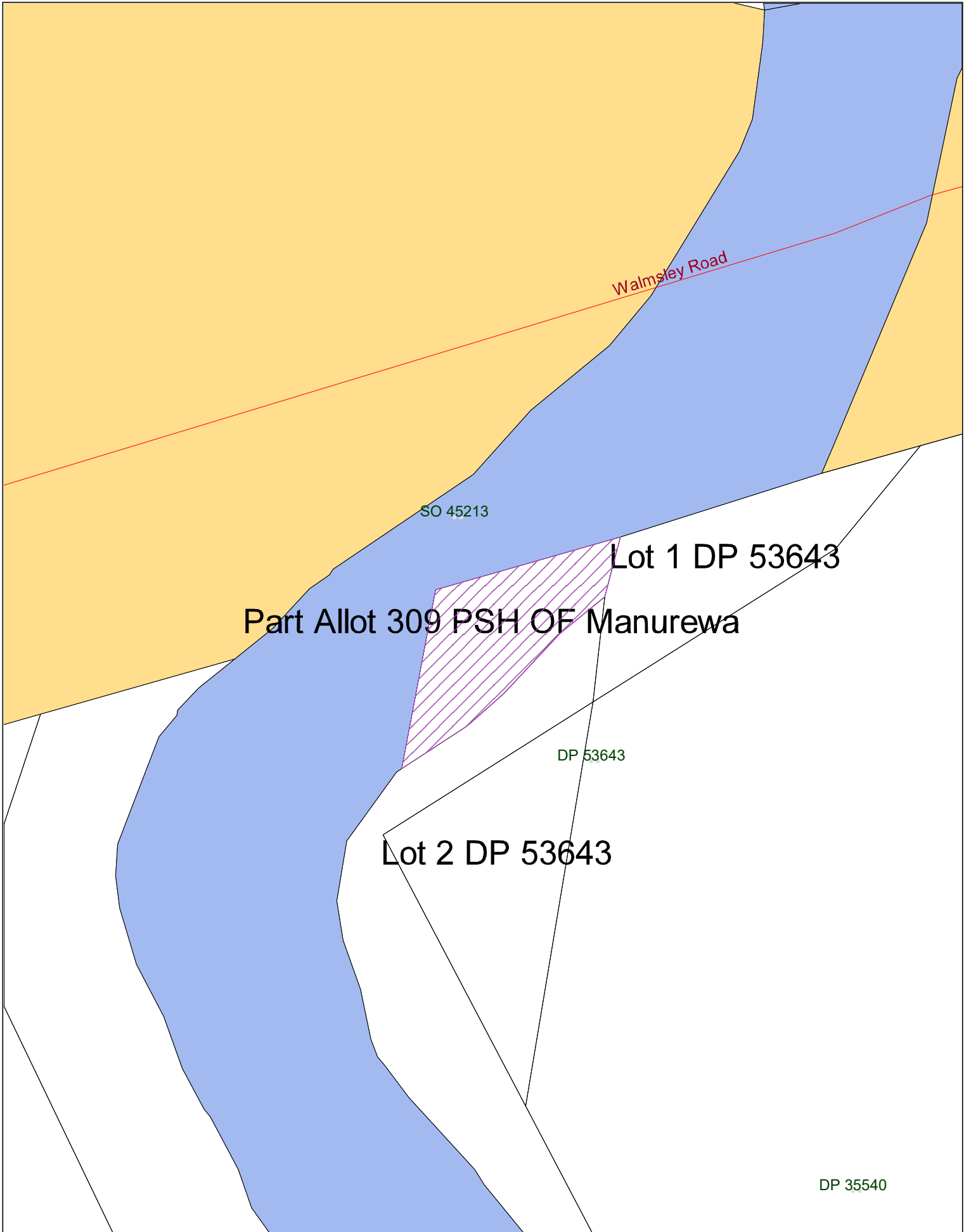

Spatial Map Print

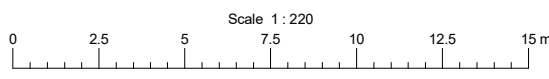

This data has been compiled from official records. Location of boundaries requires an analysis of all relevant information in compliance with the Survey Regulations. Attribute data requires an analysis of the appropriate legal record.

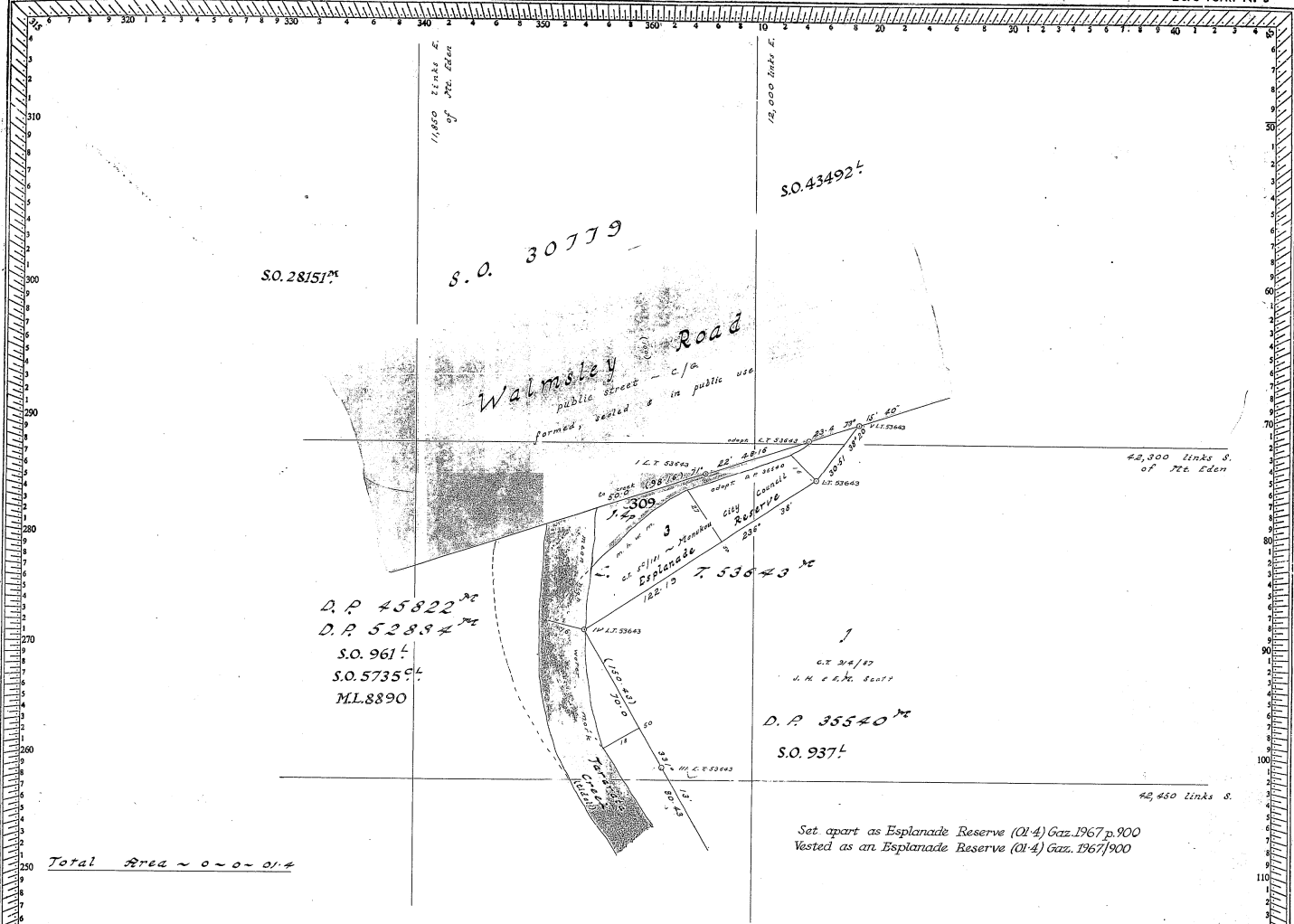

Total Area ~ 0-0-01-2

Plan of Allot 309 to be Vested as Esplanade Reserve (formerly Old Bed of Tararata Creek) Manurewa Parish

Crown Land - No Regn

CROSS REF

Received 11/11/66

File 2/51/516

Instructions _____

Reference Plans See files of _____

Field book _____

Traverse book _____

Examined by [Signature]

Recorded 11/11/66

Plan in order for approval _____

Survey Block & District Block V Otahuhu S. D.

Land District North Auckland Local Body Manukau City Council

Scale 20 links to an inch Compiled by W. H. Moore Date June 1966

I, William Moore of Auckland Registered Surveyor and holder of an annual practising certificate, hereby certify that this plan has been made from approved surveys; that the plan and measurements are correct and have been made in accordance with the regulations under the Surveyors Act, 1938

Dated at Auckland this 23rd day of June 1966

William Moore
Registered Surveyor.

Approved _____

A. H. [Signature]
Chief Surveyor 6/2/67

This space reserved for plan numbers

45213



View Statutory Action

Parcel Lot 3 Deposited Plan 35540
Current Purpose Esplanade Reserve

Parcel ID 5049290
Parcel Status Current

Statutory Action	Type	Recorded	Action	Status
DP 35540	Vesting on Deposit	04/04/2002	Create	Current

Statute Purpose Esplanade Reserve
Name
Comments

***** End of Report *****



**RECORD OF TITLE
UNDER LAND TRANSFER ACT 2017
FREEHOLD
Search Copy**



R. W. Muir
Registrar-General
of Land

Identifier **NA5C/226**
Land Registration District **North Auckland**
Date Issued 17 March 1965

Prior References

NA212/64 NA255/222

Estate Fee Simple
Area 1606 square metres more or less
Legal Description Lot 12 Deposited Plan 45822
Purpose Esplanade reserve
Registered Owners
Auckland Council

Interests

SUBJECT TO THE RESERVES AND DOMAINS ACT 1953

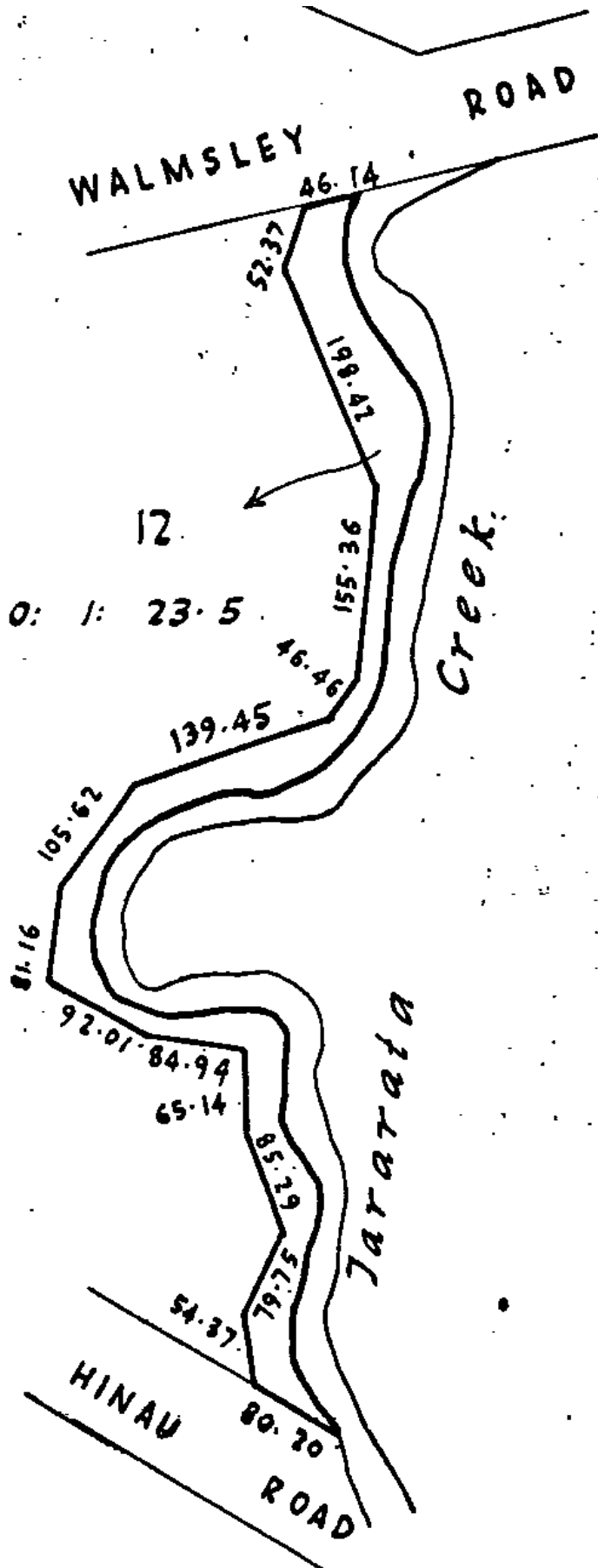



**RECORD OF TITLE
UNDER LAND TRANSFER ACT 2017
FREEHOLD
Search Copy**



R. W. Muir
Registrar-General
of Land

Identifier **NA41D/248**
Land Registration District **North Auckland**
Date Issued 16 March 1978

Prior References
NA3B/457

Estate Fee Simple
Area 37 square metres more or less
Legal Description Part Lot 1 Deposited Plan 45822
Purpose Esplanade reserve
Registered Owners
Auckland Council

Interests

Subject to a drainage right (in gross) over part in favour of The Manukau City Council created by Transfer 620811
SUBJECT TO THE RESERVES AND DOMAINS ACT 1953

