



SELWYN COLLEGE

FIBRE OPTIC AND COMMS TO CONNECT INTO EXISTING NETWORK ON KOHIMARAMA ROAD

GAS TO CONNECT INTO EXISTING NETWORK OFF JOHN RYMER PLACE

**LEGEND**

[Red dashed line]	SITE BOUNDARY
[Blue shaded area]	PROPOSED BUILDING
[Orange line]	PROPOSED GAS
[Purple line]	PROPOSED COMMS
[Green line]	PROPOSED FIBRE OPTIC
[Yellow line]	PROPOSED LV POWER SUPPLY
[Red line]	PROPOSED HV POWER SUPPLY
[Black line]	EXISTING GAS
[Black line]	EXISTING COMMS
[Black line]	EXISTING FIBRE OPTIC
[Black line]	EXISTING LV POWER SUPPLY
[Black line]	EXISTING HV POWER SUPPLY

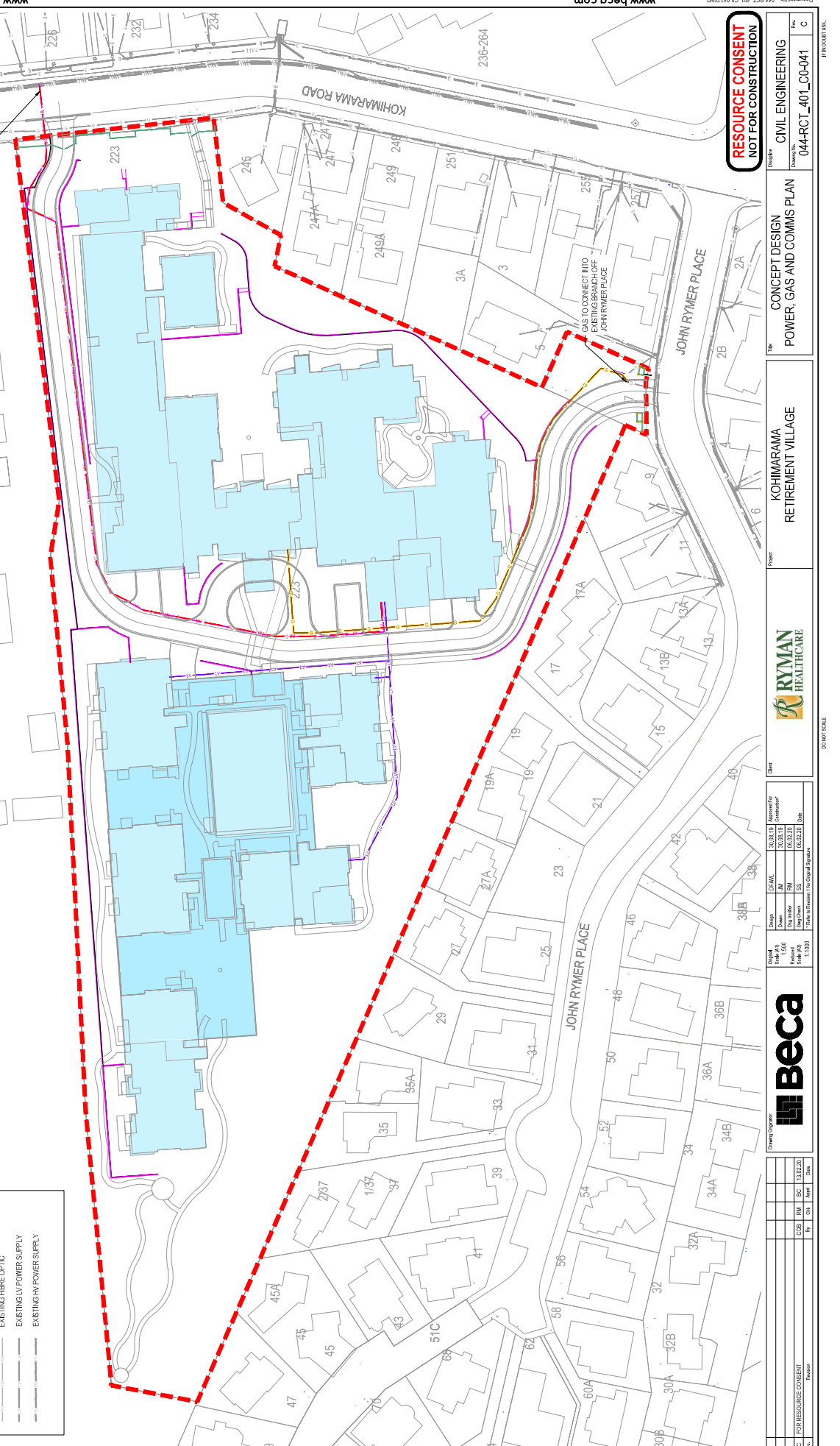

**RESOURCE CONSENT NOT FOR CONSTRUCTION**

Company: CIVIL ENGINEERING  
 Project No: 044-RCT\_401\_C0-041  
 Date: C

Project: KOHIMARAMA RETIREMENT VILLAGE  
 Title: CONCEPT DESIGN POWER, GAS AND COMMS PLAN



Check	Checked By	Date	Checked By	Date
Overall	AM	15/02/20	AM	15/02/20
Design	AM	15/02/20	AM	15/02/20
Check	AM	15/02/20	AM	15/02/20

**Beca**

Rev	Description	By	CHK	DATE
C	FOR RESOURCE CONSENT	AM	AM	13/02/20