



**RECORD OF TITLE
UNDER LAND TRANSFER ACT 2017
FREEHOLD
Search Copy**



R.W. Muir
Registrar-General
of Land

Identifier **NA105B/560**
Land Registration District **North Auckland**
Date Issued 16 September 1996

Prior References
NA105B/559

Estate Fee Simple
Area 398.0540 hectares more or less
Legal Description Lot 1-3 Deposited Plan 177738 and Lot 12
Deposited Plan 49440

Registered Owners
Stevenson Aggregates Limited

Interests

Fencing agreement in Gazette Notice C885829.1
Subject to Sections 241(2) and 242(1) Resource Management Act 1991
Appurtenant hereto is a right of way created by Transfer A150045
C948493.1 Building consent pursuant to Section 36 (2) Building Act 1991 - 31.1.1996 at 10.00 am (affects part)
D046071.8 Consent Notice pursuant to Section 221(1) Resource Management Act 1991 - 16.9.1996 at 3.23 pm
8842709.1 Notice pursuant to Section 195(2) Climate Change Response Act 2002 - - 29.8.2011 at 2:56 pm
11188338.1 Forestry Right pursuant to the Forestry Rights Registration Act 1983 to Matariki Forests - 10.8.2018 at 2:25 pm
Land Covenant in Covenant Instrument 11872768.1 - 15.12.2020 at 5:41 pm
Land Covenant in Covenant Instrument 11964629.1 - 15.12.2020 at 5:43 pm

NORTH AUCKLAND LAND DISTRICT
SURVEY DISTRICT XVII WAIRONGA
1:2500 SHEET

PLAN OF LOTS 1-3
FOR CT DIAGRAM PURPOSES

LOCAL AUTHORITY MANUKAU CITY
Prepared by 
Scale - Proportional Date

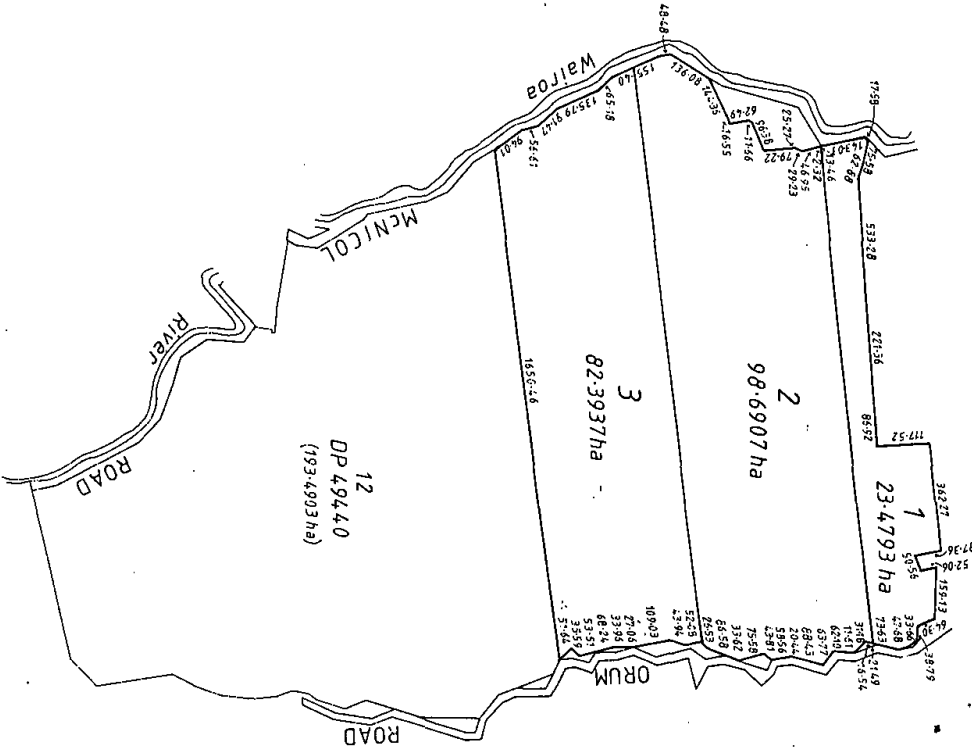

NEW CST ALLOCATED
LOTS 1-3 hereon and LOT 12 DP 49440
- 1058/560
(Total CT Area: 398.0540 ha)

PARCEL	FORMERLY	CT REF
LOT 1	Pt Allot 27 Psh of Ohau	1058/55
LOT 2	Pt Allot 28 Psh of Ohau	
LOT 3	Pt Allot 29 Psh of Ohau	
TOTAL AREA (LOTS 1-3) 204.5637 ha		

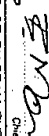
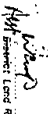
APPROVED FOR CT DIAGRAM PURPOSES
10/10/10 
DEPOSITED FOR CT DIAGRAM PURPOSES
15/04/10 
1:2500 DP 177738
10 611 838