

Memo

26 September 2016

To: Celia Davison – Unitary Plan Manager
From: Katrina David – Planner – Unitary Plan

Subject: **Amendments to the Proposed Auckland Unitary Plan – Decisions Version**

Please sign below once you have checked the following update(s) and have confirmed that the formatting and content meets the requirements of the Proposed Auckland Unitary Plan – Decision Version.

Reason for change	Designation partial uplift request from the REQUIRING AUTHORITY
Text	NA
Map	Amend the Proposed Auckland Unitary Plan - Decisions Version GIS Viewer and property summary (planning maps) to remove designation 418 Waitakere Ranges Regional Parkland from 100 Cornwallis Road, Cornwallis as shown on the attached map.

Prepared by:

Diana Luong
Planning Technician

Signature:

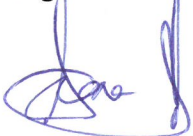

Map changes prepared by:

Shelley Glassey
Unitary Plan Geospatial Lead

Signature:



Reviewed by:

Katrina David
Planner – Unitary Plan

Signature:

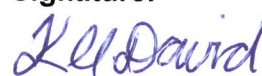

Approved by:

Tony Reidy
Unitary Plan Team Leader

Signed off by:

Celia Davison
Unitary Plan Manager

Signature:



Signature:

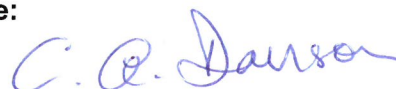

Form 23
**Notice of removal of designation or heritage order or part of
designation or heritage order**

Sections 182 and 196, Resource Management Act 1991

To: Auckland Council
And to: Allan and Bernice Hughes

Auckland Council gives notice that it no longer requires the part of the Waitakere Ranges Regional Parkland designation over 100 Cornwallis Road identified as Lot 3 (0.0605 Ha) LT 435910 as shown in attachment 1. This is due to a land exchange between Auckland Council and the private owners resulting in the land now not being part of the regional park.

Auckland Council also gives notice that the designation overlay over privately owned land at 100 Cornwallis Road, identified as Lot 2 (0.0977 Ha) LT 435910 in attachment 1, is in error and is not required to be included in the Waitakere Ranges Regional Park designation.

Auckland Council requests the territorial authority to amend the district plan accordingly as required by section 182 (or section 196) of the Resource Management Act 1991.

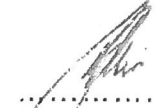

.....
Richard Hollier - *Manager Regional Parks*
Signature on behalf of requiring authority

16/9/16
.....
Date

Address: Auckland Council
Private Bag 92300
Victoria Street West
Auckland 1142

Telephone: 0276259492
email: dafydd.pettigrew@auckland.council.govt.nz
Contact: Dafydd Pettigrew – Service and Asset Planner

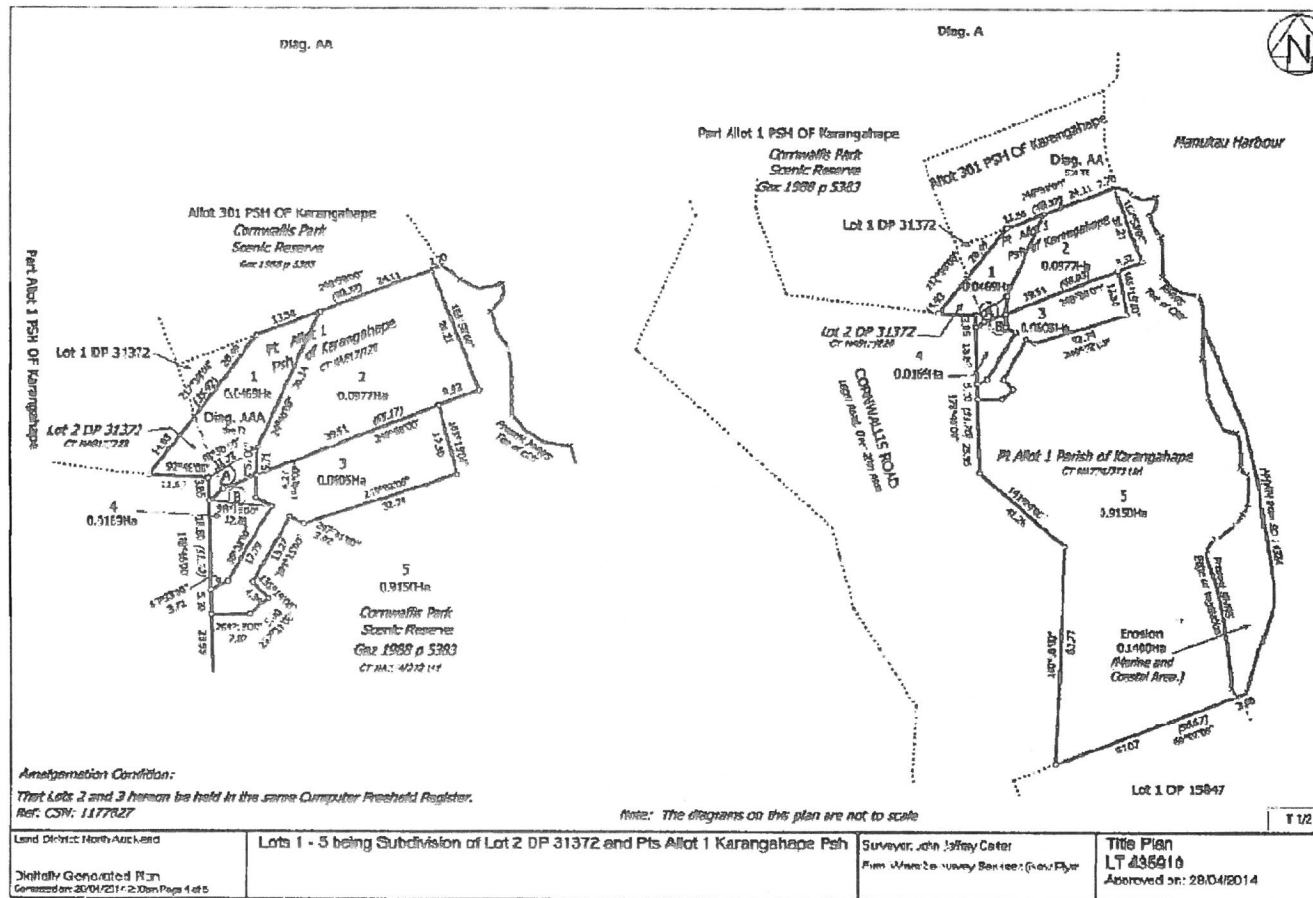
Attachment 1



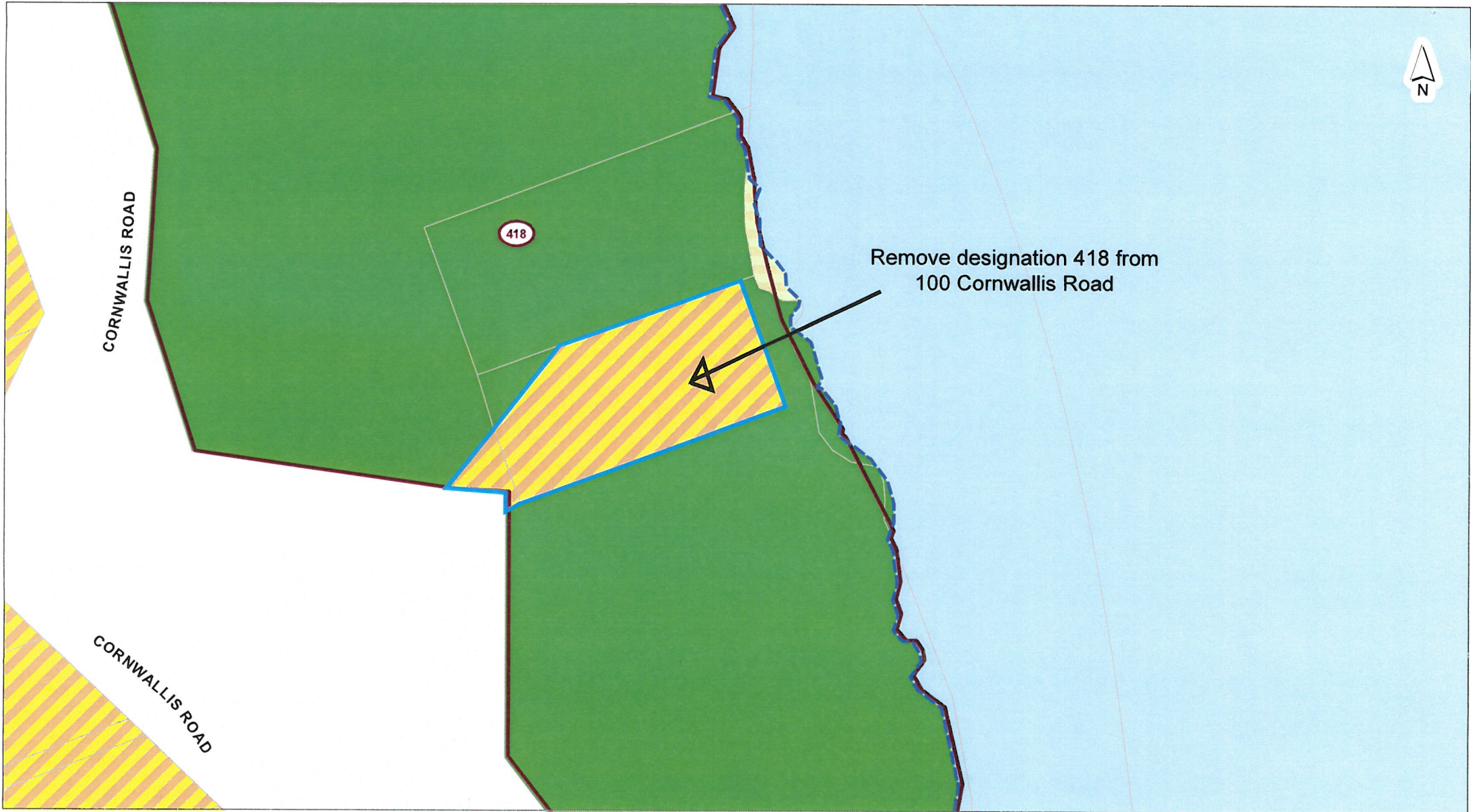

DISCLAIMER:
This map/plan is illustrative only and all information should be independently verified on site before taking any action.
Copyright Auckland Council. Land Parcel Boundary information from LINZ (Crown Copyright Reserved). Whilst due care has been taken, Auckland Council gives no warranty as to the accuracy and plan completeness of any information on this map/plan and accepts no liability for any error, omission or use of the information. Height datum: Auckland 1946.

Remove designation 418 from 100 Cornwallis Road

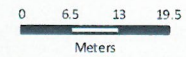

Scale @ A4
= 1:1,000

Date Printed:
26/09/2016



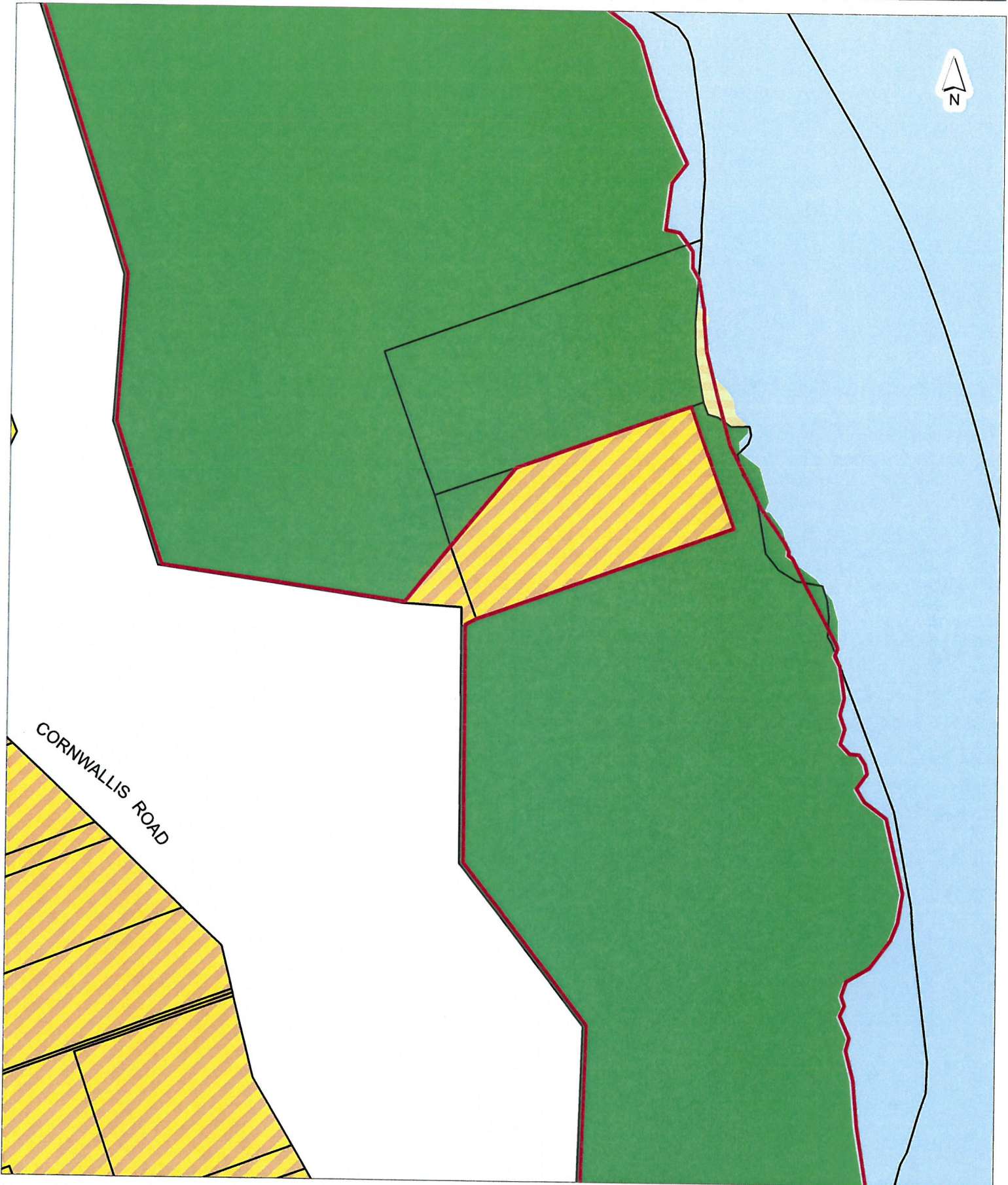

DISCLAIMER:
This map/plan is illustrative only and all information should be independently verified on site before taking any action. Copyright Auckland Council. Land Parcel Boundary information from LINZ (Crown Copyright Reserved). Whilst due care has been taken, Auckland Council gives no warranty as to the accuracy and plan completeness of any information on this map/plan and accepts no liability for any error, omission or use of the information. Height datum: Auckland 1946.

**Designation 418 removed from
100 Cornwallis Road**

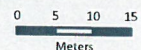

Scale @ A4
= 1:1,000

Date Printed:
12/10/2016



Auckland Council
Te Kaitiaki o Tāmaki Makaurau